

Price and Specification Guide
11 July 2023 | Model Year 2023B



Astra

Including Electric and Plug-in Hybrid GSe

Contents

To find the information you want use the links below to navigate around the guide:

[Vauxhall Pure Technology](#)

[Choose your trim level](#)

[Prices](#)

[Vauxhall PureSense](#)

[Vauxhall PureConnect](#)

[Comfort and convenience](#)

[Safety and security](#)

[Styling](#)

[Exterior colours](#)

[Vauxhall PureEnergy](#)

[Specifications](#)

[Dimensions and capacities](#)

[Company car information](#)

[Further information](#)

[Owners information](#)

Vauxhall Pure Technology

We believe technology works best when it works for everyone. When it's not just as smart as can be, but also as easy as can be. We call it Vauxhall Pure Technology. Now everyone can feel the instant excitement of electric. Everyone can keep themselves and their loved ones safe. And everyone can stay connected to the things that matter most, simply and easily. That's Vauxhall Pure Technology. No gimmicks, nothing complicated, just technology that makes driving better, easier and more exciting, for everyone.



Vauxhall PureSense

Vauxhall PureSense gives you heightened awareness on the road, with smart driver assistance technology that makes every journey safer and more enjoyable. And the best bit? You don't have to do a thing. PureSense is always on, continually working away in the background, scanning the road ahead, keeping you safe and allowing you to just enjoy the drive.



Vauxhall PureConnect

We live in a connected world. Friends and relatives are only a button away. We play music on demand. Information is instant. At Vauxhall we've brought your connected world inside the car – we call it PureConnect. Easy to use and always on, PureConnect seamlessly connects you to the things that matter through the smooth, flowing Pure Panel display. And, just as intelligently, it connects you to your car's onboard tech, through touchscreen and voice control.

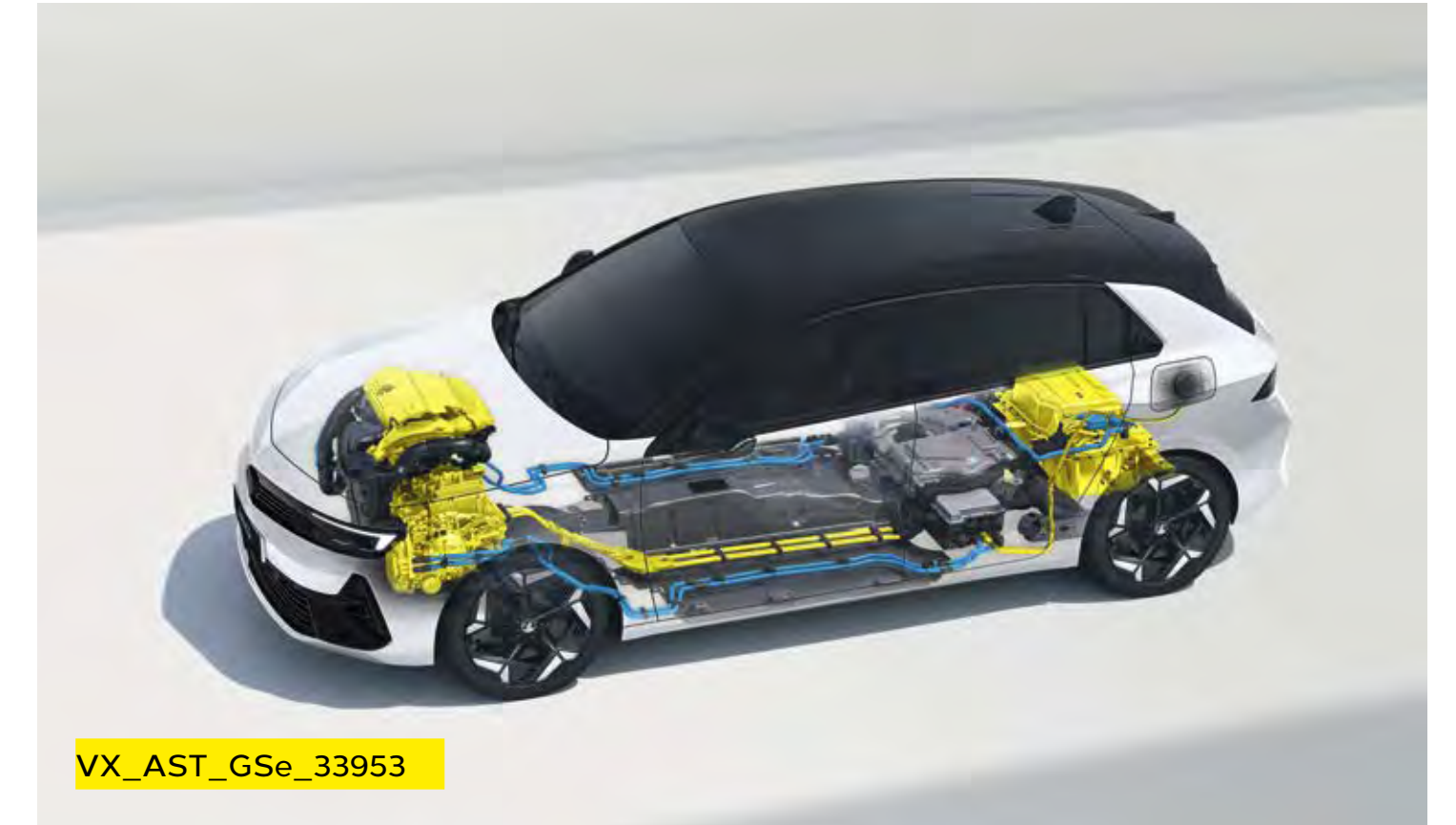

Vauxhall PureEnergy

At Vauxhall, we're on a mission to open up electric driving to everyone. To deliver instant, exhilarating performance with low emissions. To change the way we move, for the better. And with innovative Plug-in Hybrid/Electric models available across the range, including the all-new 225PS GSe model, there's an electrified Astra that will fit seamlessly into your life. One that's more exciting than ever, while keeping costs as low as possible. Thanks to PureEnergy from Vauxhall.

Choose your trim level

Design

Inject a little excitement into your commute with the Design, including plenty of 'must have' features as standard.



GS

Step up to our sporty GS. It's kitted out with a whole host of features that make it fun to drive, and great to look at.

Also available as fully Electric and Plug-in Hybrid models.



Ultimate

All you could ask for; our Ultimate model has it all.

Also available as fully Electric and Plug-in Hybrid models.*



*Hatchback model only.

GSe

The new GSe (Grand Sport electric) radically redefines pure performance. Combining bold design with exhilarating, electrified technology. This is responsible, high-energy excitement.



Design



16-inch alloy wheel.



PureSense

- LED headlights and tail lights
- LED daytime running lights
- LED front fog lights
- Automatic lighting control
- High beam assist
- Electronic parking brake
- Front and rear parking distance sensors
- Lane departure warning with lane keep assist
- Speed sign recognition
- Driver drowsiness alert
- Forward collision alert (low speed)
- Automatic emergency braking with pedestrian detection
- Cruise control with intelligent speed adaption
- Eight airbags
- Remote control security alarm system
- Hill start assist
- In-crash braking
- ISOFIX child seat fixings on outer rear seats

PureConnect

- Multimedia Pure Panel Navigation system
 - 10-inch colour touchscreen
 - 10-inch digital instrument cluster
 - AM/FM/DAB digital radio
 - Bluetooth®
 - Natural voice recognition
 - Wireless Apple CarPlay/Android Auto™
 - Front USB connection
- Six speakers
- Vauxhall Connect

Comfort and convenience

- Electronic climate control
- Flat-bottomed leather-covered steering wheel
- Steering wheel audio/phone/cruise controls
- 60/40 split-folding rear seat backs (Hatchback only)
- 40/20/40 split-folding rear seat backs with remote easy-fold facility (Sports Tourer only)
- Flex load floor with luggage restraining nets (pair, Sports Tourer only)
- Rain-sensitive windscreen wipers
- Electrically operated front and rear windows
- Electrically adjustable/heated door mirrors
- Soundproofed insulated windscreen
- Keyless start
- Intelli-Space (Sports Tourer only)
- Emergency tyre inflation kit

Interior

- Driver's seat (six-way adjustable)
- Front passenger's seat (four-way adjustable)
- Black facia with Modene trim inserts
- Instrument panel bar Alexit Grey
- Birdie Grey trim inserts on front doors
- Jet Black Modene seat trim inserts
- Jet Black Modene fabric side bolsters and surrounds

Styling

- Body-colour front and rear bumpers
- 16-inch silver alloy wheels with 205/55 R 16 tyres
- Chrome-effect Griffin logo
- Black vizor frame
- Black lower window moulding

GS



VX_AST_34159

GS Petrol/Plug-in Hybrid.



VX_AST_e_34283

GS Electric.



VX_AST_33740

VX_AST_32866_QOJ



17-inch alloy wheel.



VX_AST_32867_PU2

18-inch alloy wheel (extra cost option).**

VX_AST_e_34294



18-inch alloy wheel.

PureSense

- LED headlights and tail lights
- LED daytime running lights
- LED front fog lights
- Automatic lighting control
- High beam assist
- Electronic parking brake
- Front and rear parking distance sensors
- Lane departure warning with lane keep assist
- Driver drowsiness alert
- Automatic emergency braking with pedestrian detection
- Eight airbags
- Hill start assist
- Remote control security alarm system
- In-crash braking
- ISOFIX child seat fixings on outer rear seats

PureConnect

- Multimedia Pure Panel Navigation system
 - 10-inch colour touchscreen
 - 10-inch digital instrument cluster
 - AM/FM/DAB digital radio
 - Bluetooth®
 - Natural voice recognition
 - Wireless Apple CarPlay/Android Auto™
 - Front USB connection
- Six speakers
- Vauxhall Connect

Comfort and convenience

- Steering wheel audio/phone/cruise controls
- Flex load floor with luggage restraining nets (pair, Sports Tourer Petrol only)
- Rain-sensitive windscreen wipers
- Electrically operated front and rear windows
- Electrically adjustable/heated door mirrors
- Soundproofed insulated windscreen
- Intelli-Space (Sports Tourer Petrol only)
- Emergency tyre inflation kit

Features over and above Design:

PureSense

- Traffic sign recognition
- Forward collision alert (all speed)
- Adaptive cruise control with intelligent speed adaptation

PureConnect

- Pure Panel Pro digital display
- Intelli-Vision 360° panoramic parking camera

Comfort and convenience

- Dual-zone electronic climate control
- Heated perforated flat-bottomed leather-covered steering wheel
- Driver's ergonomic active sports-style seat (AGR approved*) • Heated front seats
- Paddle shift (excluding manual/Electric)
- Front centre armrest with cup holder
- Centre rear seat armrest and load-through facility
- Flex load floor
- Frameless automatic anti-dazzle rear-view mirror
- Keyless entry and start
- Interior ambient lighting

Interior

- Ergonomic active sports-style driver's seat (eight-way adjustable)
- Black facia with Isabella trim inserts
- Instrument panel bar Liquid Palladium
- Mistral Black trim inserts on front doors
- Jet Black Greta fabric seat trim inserts
- Jet Black Greta side bolsters and surrounds

Styling

- Sports-style front and rear bumpers
- 17-inch black alloy wheels with 225/45 R 17 tyres (Petrol/Plug-in Hybrid only) • 18-inch black alloy wheels with 215/45 R 18 tyres (Electric only)
- Black Griffin logo and vizer frame
- Dark-tinted rear windows
- Black roof and interior headliner
- Alloy-effect sports pedals

*AGR (The Campaign for Healthier Backs) is an independent centre of excellence for ergonomics, based in Germany. **For more information see Hatchback Styling page, click [here](#)

Ultimate



VX_ASST_PHEV_34285

Ultimate Petrol/Plug-in Hybrid.



VX_AST_e_34284

Ultimate Electric.



VX_AST_PHEV_32912



VX_AST_32868_PU1

18-inch alloy wheel.

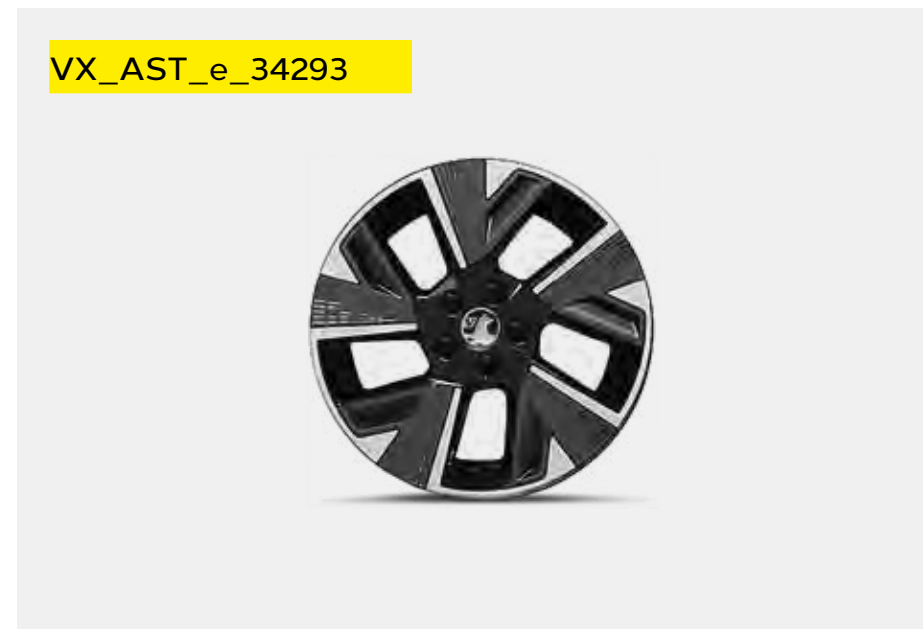

VX_AST_e_34293

18-inch alloy wheel.

PureSense

- LED daytime running lights
- LED front fog lights
- Automatic lighting control
- High beam assist
- Electronic parking brake
- Front and rear parking distance sensors
- Lane departure warning with lane keep assist
- Traffic sign recognition
- Driver drowsiness alert
- Forward collision alert (low speed)
- Automatic emergency braking with pedestrian detection
- Eight airbags
- Hill start assist
- Remote control security alarm system
- In-crash braking
- ISOFIX child seat fixings on outer rear seats

PureConnect

- Multimedia Pure Panel Pro Navigation system
 - 10-inch colour touchscreen
 - 10-inch digital instrument cluster
 - AM/FM/DAB digital radio
 - Bluetooth®
 - Natural voice recognition
 - Wireless Apple CarPlay/Android Auto™
 - Front USB connection
- Vauxhall Connect

Comfort and convenience

- Flat-bottomed leather-covered steering wheel
- Steering wheel audio/phone/cruise controls
- Rain-sensitive windscreen wipers
- Electrically operated front and rear windows
- Electrically adjustable/heated door mirrors
- Soundproofed insulated windscreen
- Keyless entry and start
- Emergency tyre inflation kit

Features over and above GS:

PureSense

- IntelliLux adaptive LED® pixel headlights
- Lane change assist with side blind spot alert
- Lane positioning assist
- Rear cross traffic alert
- Semi-autonomous lane change**
- Advanced intelligent speed adaptation**

PureConnect

- Hi-fi with eight speakers (Petrol/Plug-in Hybrid only)
- Intelli-HUD (Head-Up Display)
- Wireless charger for mobile devices

Comfort and convenience

- Dual-zone electronic climate control with Intelli-Air (air quality sensor)
- Heated soundproofed insulated windscreen
- Heated ergonomic active sports-style front seats (AGR approved*)
- Panoramic sunroof
- Power tailgate (Sports Tourer only)

Interior

- Driver's seat
 - 10-way electrically adjustable (Petrol/Plug-in Hybrid only)
 - 8-way electrically adjustable (Electric only)
- Front passenger's seat (eight-way adjustable – Petrol/Plug-in Hybrid only)
- Black facia with high gloss black inserts
- Alcantara interior seat and door trim inserts
- Alcantara side bolsters and surrounds

Styling

- 18-inch diamond-cut alloy wheels with grey inserts and 225/40 R 18 tyres (Petrol/Plug-in Hybrid only)
- 18-inch diamond-cut alloy wheels with 215/45 R 18 tyres (Electric only)
- High gloss black roof rails (Sports Tourer only)

*AGR (The Campaign for Healthier Backs) is an independent centre of excellence for ergonomics, based in Germany. **Not available with manual transmission.

GSe



18-inch alloy wheel.



PureSense

- LED daytime running lights
- LED front fog lights
- Automatic lighting control
- High beam assist
- Electronic parking brake
- Front and rear parking distance sensors
- Lane departure warning with lane keep assist
- Speed sign recognition
- Driver drowsiness alert
- Forward collision alert (low speed)
- Automatic emergency braking with pedestrian detection
- Eight airbags
- Remote control security alarm system
- In-crash braking
- ISOFIX child seat fixings on outer rear seats

PureConnect

- Multimedia Pure Panel Pro Navigation system
 - 10-inch colour touchscreen
 - 10-inch digital instrument cluster
 - AM/FM/DAB digital radio
 - Bluetooth®
 - Natural voice recognition
 - Wireless Apple CarPlay/Android Auto™
 - Front USB connection
- Six speakers
- Vauxhall Connect

Comfort and convenience

- Flat-bottomed leather-covered steering wheel
- Steering wheel audio/phone/cruise controls
- Rain-sensitive windscreen wipers
- Electrically operated front and rear windows
- Electrically adjustable/heated door mirrors
- Soundproofed insulated windscreen
- Keyless entry and start
- Emergency tyre inflation kit

Features over and above GS:

PureSense

- IntelliLux adaptive LED® pixel headlights
- Lane change assist with side blind spot alert
- Lane positioning assist
- Rear cross traffic alert
- Semi-autonomous lane change
- Advanced intelligent speed adaptation

PureConnect

- Intelli-HUD (Head-Up Display)
- Wireless charger for mobile devices

Comfort and convenience

- Dual-zone electronic climate control with Intelli-Air (air quality sensor)
- Heated soundproofed insulated windscreen
- GSe performance heated front seats (AGR approved*)
- Power tailgate (Sports Tourer only)

Interior

- Driver's seat (10-way electrically adjustable) with memory function
- Front passenger's seat (eight-way adjustable)
- Black facia with high gloss black inserts
- Instrument panel bar Liquid Palladium
- Alcantara inserts on front doors
- Alcantara seat trim inserts
- Alcantara side bolsters and surrounds

Styling

- Unique GSe front and rear bumpers
- 18-inch gloss black bi-colour diamond-cut alloy wheels with 225/40 R 18 tyres
- High gloss black roof rails (Sports Tourer only)
- GSe badge

*AGR (The Campaign for Healthier Backs) is an independent centre of excellence for ergonomics, based in Germany.

Prices

Electric	LCDV code	Price (£)	VAT (£)	Total (£)	On-the-road RRP (£)	Financial year 2023/24 BiK 20% (£)	WLTP combined CO ₂ (g/km) - LCDV code	Insurance groups
Hatchback								
GS								
Electric Propulsion (156PS) auto	1GO5A5TZIFTOAOC5	32,658.33	6,531.67	39,190.00	40,145.00	13.36	0	26E
Ultimate								
Electric Propulsion (156PS) auto	1GO5A5TZIFTO4OC5	35,254.17	7,050.83	42,305.00	43,260.00	14.40	0	26E

Plug-in Hybrid	LCDV code	Price (£)	VAT (£)	Total (£)	On-the-road RRP (£)	Financial year 2023/24 BiK 20% (£)	WLTP combined CO ₂ (g/km) [#] - LCDV code	Insurance groups
Hatchback								
GS								
1.6 (180PS) Turbo/Electric auto	1GO5A5TR8AT0AOC5	30,816.67	6,163.33	36,980.00	37,935.00	12.63	23	26E
Ultimate								
1.6 (180PS) Turbo/Electric auto	1GO5A5TR8AT04OC5	33,412.50	6,682.50	40,095.00	41,050.00	13.67	24	28E
GSe								
1.6 (225PS) Turbo/Electric auto	1GO5A5ZR7AT0AOC5	33,537.50	6,707.50	40,245.00	41,200.00	13.72	25	31E
Sports Tourer								
GS								
1.6 (180PS) Turbo/Electric auto	1GO5C5TR8AT0AOC5	31,816.67	6,363.33	38,180.00	39,135.00	52.11	23	27E
Ultimate								
1.6 (180PS) Turbo/Electric auto	1GO5C5TR8AT04OC5	34,579.17	6,915.83	41,495.00	42,450.00	56.53	25	tba
GSe								
1.6 (225PS) Turbo/Electric auto	1GO5C5ZR7AT0AOC5	35,370.83	7,074.17	42,445.00	43,400.00	86.69	26	31E

WLTP combined CO₂ (g/km) figures are based on a configured vehicle as per LCDV code for UK with no options fitted.

[#]Provisional fuel consumption and CO₂ figures are determined according to the WLTP test cycle. CO₂ figures, BiK values and RRP pricing shown above are for a standard vehicle without any additional optional equipment. CO₂ figures are used to calculate Vehicle Excise Duty (VED) for the first registration of the vehicle and BiK. The addition of optional extras could increase the certified CO₂ emission output. This in turn may affect the amount of VED payable upon registration, and, for company car drivers, the P11D value and the amount of Benefit in Kind (BiK) tax payable. Figures shown are for comparison purposes and should only be compared to the fuel consumption and CO₂ values of other cars tested to the same technical standard. The fuel consumption achieved, and CO₂ produced, in real world conditions will depend upon a number of factors including, but not limited to: the accessories fitted (pre and post registration); variations in weather; driving styles and vehicle load. The WLTP (Worldwide Harmonised Light Vehicles Test Procedure) is used to measure fuel consumption and CO₂ figures. Full data relating to WLTP test cycles can be found at: www.vauxhall.co.uk/wltp

Please note: On-the-road recommended retail prices (RRP) include number plates and delivery to Retailer of £900.00 (including £150.00 VAT), 12 months' Vehicle Excise Duty and new vehicle first registration fee of £55.00. Excludes fuel and insurance. Company Car Benefit in Kind (BiK) rates are monthly based on the standard paint price.

Prices

Petrol	LCDV code	Price (£)	VAT (£)	Total (£)	On-the-road RRP (£)	Financial year 2023/24 BiK 20% (£)	WLTP combined CO ₂ (g/km) [#] - LCDV code	Insurance groups
Hatchback								
Design								
1.2 (110PS) Turbo	1GO5A5LL5KT0AOC5	21,495.83	4,299.17	25,795.00	26,960.00	129.03	123	16E
1.2 (130PS) Turbo	1GO5A5LM6KT0AOC5	21,995.83	4,399.17	26,395.00	27,560.00	131.93	123	17E
1.2 (130PS) Turbo auto	1GO5A5LM61T0AOC5	23,245.83	4,649.17	27,895.00	29,060.00	143.98	125	18E
GS								
1.2 (130PS) Turbo	1GO5A5TM6KT0AOC5	23,908.33	4,781.67	28,690.00	29,855.00	147.95	125	19E
1.2 (130PS) Turbo auto	1GO5A5TM61T0AOC5	25,158.33	5,031.67	30,190.00	31,355.00	155.45	127	18E
Ultimate								
1.2 (130PS) Turbo	1GO5A5TM6KT04OC5	26,504.17	5,300.83	31,805.00	32,970.00	163.53	128	20E
1.2 (130PS) Turbo auto	1GO5A5TM61T04OC5	27,754.17	5,550.83	33,305.00	34,515.00	176.73	131	20E
Sports Tourer								
Design								
1.2 (110PS) Turbo	1GO5C5LL5KT0AOC5	22,495.83	4,499.17	26,995.00	28,160.00	139.48	125	16E
1.2 (130PS) Turbo	1GO5C5LM6KT0AOC5	22,995.83	4,599.17	27,595.00	28,760.00	142.48	126	18E
1.2 (130PS) Turbo auto	1GO5C5LM61T0AOC5	24,245.83	4,849.17	29,095.00	30,260.00	149.98	128	19E
GS								
1.2 (130PS) Turbo	1GO5C5TM6KT0AOC5	24,908.33	4,981.67	29,890.00	31,055.00	153.95	128	19E
1.2 (130PS) Turbo auto	1GO5C5TM61T0AOC5	26,158.33	5,231.67	31,390.00	32,555.00	166.83	130	19E
Ultimate								
1.2 (130PS) Turbo	1GO5C5TM6KT04OC5	27,670.83	5,534.17	33,205.00	34,415.00	176.21	131	19E
1.2 (130PS) Turbo auto	1GO5C5TM61T04OC5	28,920.83	5,784.17	34,705.00	35,915.00	183.96	134	20E

WLTP combined CO₂ (g/km) figures are based on a configured vehicle as per LCDV code for UK with no options fitted.

[#]Provisional fuel consumption and CO₂ figures are determined according to the WLTP test cycle. CO₂ figures, BiK values and RRP pricing shown above are for a standard vehicle without any additional optional equipment. CO₂ figures are used to calculate Vehicle Excise Duty (VED) for the first registration of the vehicle and BiK. The addition of optional extras could increase the certified CO₂ emission output. This in turn may affect the amount of VED payable upon registration, and, for company car drivers, the P11D value and the amount of Benefit in Kind (BiK) tax payable. Figures shown are for comparison purposes and should only be compared to the fuel consumption and CO₂ values of other cars tested to the same technical standard. The fuel consumption achieved, and CO₂ produced, in real world conditions will depend upon a number of factors including, but not limited to: the accessories fitted (pre and post registration); variations in weather; driving styles and vehicle load. The WLTP (Worldwide Harmonised Light Vehicles Test Procedure) is used to measure fuel consumption and CO₂ figures. Full data relating to WLTP test cycles can be found at: www.vauxhall.co.uk/wltp

Please note: On-the-road recommended retail prices (RRP) include number plates and delivery to Retailer of £900.00 (including £150.00 VAT), 12 months' Vehicle Excise Duty and new vehicle first registration fee of £55.00. Excludes fuel and insurance. Company Car Benefit in Kind (BiK) rates are monthly based on the standard paint price.

PureSense



1. Intelli-Drive 2.0 (Includes following four features):

Advanced intelligent speed adaptation

When a new speed limit is detected by traffic sign recognition, the system displays the speed and 'OK?' flashes for a few seconds in the driver Information cluster. If rain is detected, the system will suggest a lower speed than the set speed to adapt to the prevailing weather conditions.

Semi-automated lane change assist

The system assists drivers with lane change manoeuvres between 45 and 70mph. If the required conditions are met, the message 'OK?'

is displayed in the driver information cluster, accompanied by an acoustic signal.

Lane positioning assist

This works as a semi-automatic system that helps you integrate into a motorway lane, follow a particular lane, or follow a vehicle ahead.

Rear cross traffic alert

Rear cross traffic alert is radar-based and uses rear bumper sensors to detect moving objects to the rear sides of the vehicle when reversing. The system is able to detect cars, trucks, motorcycles, bicycles and pedestrians.

2. Lane departure warning with lane keep assist

If the driver has not actively steered or signalled, the lane departure warning system warns when the car moves outside of lane markings at speeds above 37mph.

3. Intelli-HUD (Head-Up Display)

The innovative Intelli-HUD head-up display projects the essential driving information onto the windscreen, in the driver's field of vision. Thanks to its resolution and its wide projection size, it gives a more realistic view of the information. Popups such as media, alerts, receiving calls and phone book can be displayed independently.

4. Adaptive cruise control

Adaptive cruise control uses the radar system to adjust the vehicle's speed to maintain a safe distance from the vehicle ahead, up to the speed limit set.

5. Intelli-Vision

Intelli-Vision is a video assistance function for all low-speed manoeuvres. It uses four cameras (front/rear/lateral in door mirrors) and is activated automatically when the car is put into reverse.

PureSense

Model specific features are outlined in the separate tabular information.

Model specific features	Design	GS	GS Plug-in Hybrid/Electric	Ultimate	Ultimate Plug-in Hybrid/Electric	GSe Plug-in Hybrid
Driver assistance						
Automatic emergency braking with pedestrian detection	●	●	●	●	●	●
Cruise control with intelligent speed adaptation	●	●	●	●	●	●
Driver drowsiness alert	●	●	●	●	●	●
Lane departure warning with lane keep assist	●	●	●	●	●	●
Electronic parking brake	●	●	●	●	●	●
Front and rear parking distance sensors	●	●	●	●	●	●
Speed sign recognition	●	●	●	●	●	●
Extended traffic sign recognition		●	●	●	●	●
Intelli-Vision 360° panoramic parking camera		●	●	●	●	●
Adaptive cruise control		●	●	●	●	●
Intelli-HUD (Head-Up Display)				●	●	●
Intelli-Drive 2.0 - Semi-automated lane change assist with side blind spot alert/Advanced intelligent speed adaptation/Lane positioning assist/Rear cross traffic alert				auto only	●	●
Exterior lighting						
LED headlights, front fog and tail lights	●	●	●	●	●	●
High beam assist	●	●	●	●	●	●
LED daytime running lights	●	●	●	●	●	●
Automatic lighting control	●	●	●	●	●	●
IntelliLux adaptive LED® pixel headlights				●	●	●

PureConnect

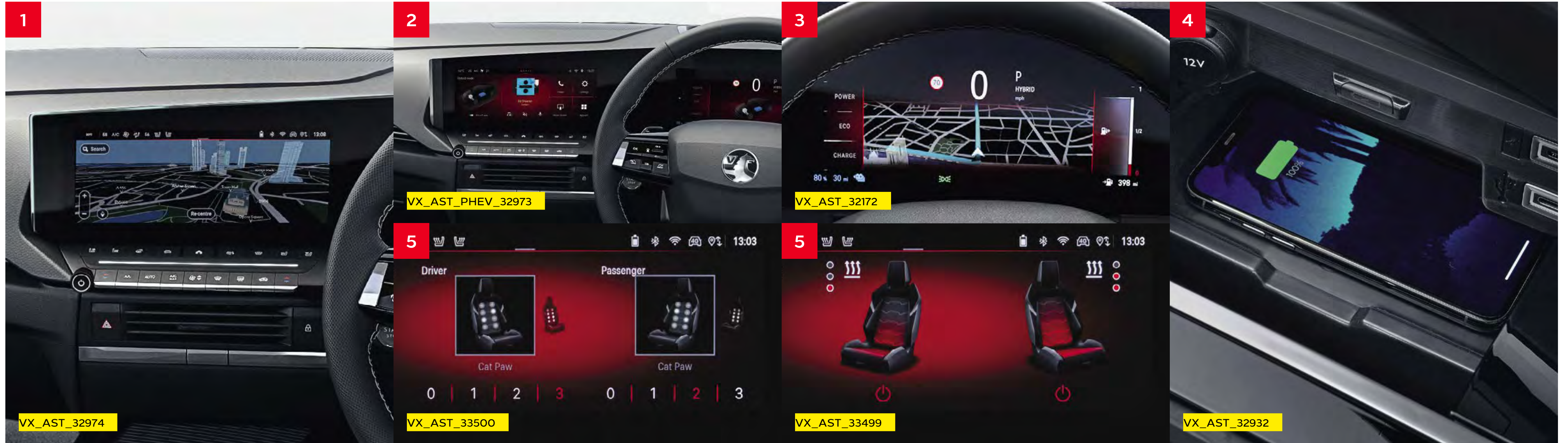

1. Natural voice recognition*

Works with 'wake-up' command 'Hey Vauxhall' to control the following functions:

- Satellite navigation commands
- Phone connectivity functions
- Choice of music playback
- Operation of electronic climate control

Personalisation

The new Pure Panel features a smartphone-like user interface with virtual shortcuts, driver recognition via smartphone and advanced profile management.

2. Central display

The app wall on the 10-inch infotainment touchscreen provides direct access to the main domains such as electronic climate control, navigation, radio, phone, seat and mirror configuration.

2. Wireless smartphone interface

Wireless smartphone projection that allows operations via voice command, touchscreen and buttons to control apps and music playback with Apple CarPlay and Android Auto™ compatibility.

3. Instrument cluster

The driver can customise the content shown on the fully digital 10-inch driver information cluster by selecting via the left stalk. In addition pop-ups such as receiving calls and alerts can be displayed.

4. Inductive wireless smartphone charger – Standard on Ultimate and GSe models only

Smartphones can be charged inductively on the charging pad in the front of the centre console.

5. AGR front seats**

The AGR label confirms that the new Astra's ergonomically certified AGR seats meet even the highest levels of comfort. And included with the Leather option on Ultimate models 3-stage seat heating, massage function and seat ventilation. The option also features a driver's seat adjustment with memory function.

PureConnect

The following features are standard across the entire Astra range.

Pure Panel digital display

Pure Panel technology makes driving more intuitive, with a flowing design that presents the information you need. With a 10-inch infotainment colour touchscreen and 10-inch digital instrument cluster right in front of you, you can stay focused on the road ahead.

- GS, Ultimate and GSe models feature the Pure Panel Pro digital display with edge-to-edge glass finish.

EV information display

- Powerflow display – Informs drivers on the current state of charge and what is being used as the power source, petrol or electric
- Charge display – displays an image of the charge port with the corresponding LED charge indication lights
- e-Save – enables the driver to determine how much battery energy needs to be conserved to ensure that the vehicle reaches its destination when in a zero emission zone
There are three options:
 - 6 mile range reserve
 - 12 mile range reserve
 - Maximum reserve
- Statistics – The Statistics display the average consumption data over a period of time using colour coded graphs
- Green: Energy recovered by braking phases and partial recharging by the petrol engine (kWh/mile)
- Blue: Energy consumed by the vehicle directly by the battery (kWh/mile)
- Orange: Fuel consumption (mpg)

Digital instrumentation

- Digital speedometer and rev counter
- Satellite Navigation display
- Digital fuel gauge with low fuel level warning light
- Digital water temperature gauge with warning light
- Shift-up/down indication light – Indicates when to change gear for optimum fuel economy

Driver information display

(centrally located in digital instrument cluster)

- Total mileage
- Service-due indicator
- Oil life
- Tyre pressure monitoring system

Multi-function trip computer

(displayed on digital instrument cluster)

- Trip mileage
- Vehicle range based on remaining fuel
- Average speed
- Average fuel economy
- Instantaneous fuel economy
- Driving time

Digital central fascia display

- Audio information
- Digital clock with automatic RDS time adjustment
- Outside air temperature with ice warning function

Infotainment

Onboard features

- Satellite navigation system with natural voice recognition
- 2D/3D street level mapping
- European coverage
- Points-of-interest search
- Map updates via USB
- DAB Digital radio
- RDS with Traffic Programme
- AM/FM stereo radio with 36 station presets
- Six speakers (Ultimate models – eight)
- Customizable screen adaption with enhanced profile management and driver recognition
- Heating, Ventilation and Air Conditioning (HVAC) user interface
- Over-the-air updates (e.g. for software)
- WiFi updates (e.g. content download)

Media connections

- USB connection with iPod control
- Bluetooth® A2DP audio streaming (Advanced Audio Distribution Profile)

Mobile phone portal

- Bluetooth® connectivity
- Vehicle microphone
- Handsfree calls via steering wheel controls
- Phone book access – Contacts/last calls/missed calls etc are mirrored on the display and are easily navigated using the touchscreen (features dependent on mobile phone)
- SMS read out and reply

Additional features

- Steering wheel mounted audio controls
- Shark fin aerial

Drive Smart

- Live navigation provided by TomTom®
- Real time traffic news
- Parking prices and availability
- Weather information
- Natural voice recognition
- Fuel prices
- Charging station search
- Quick search for addresses and points of interest
- Road safety alerts

Vauxhall Connect

Vauxhall Connect* is the smart way to stay connected while on the road. Innovative technology systems and related services keep our drivers safe and provide an exciting, efficient yet safe trip.



Safety

The more you know, the safer your journey – that's why our smart tech and connected services keep you constantly updated on what's going on inside and outside your vehicle.

Peace of mind

- Emergency call (SOS e-call)
- Breakdown call (b-call)

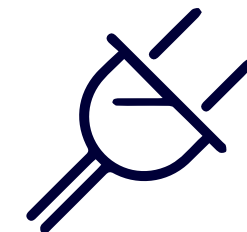

e-Remote control

Want seamless charging and added levels of comfort? Use e-Remote to schedule charging times, keep an eye on your range and even pre-set your vehicle's cabin temperature before you get in.

Convenience

- E-remote control (Plug-in Hybrid/Electric only)**
- Remote check of battery level, programming and charge management
- Pre-conditioning of vehicle temperature

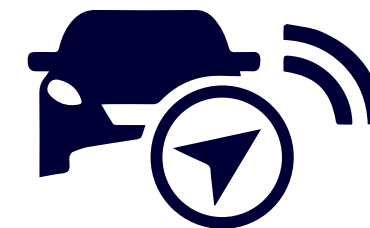

Live navigation plus[†]

With real-time directions and traffic information from the leading European GPS provider, TomTom®, every journey will be a breeze.

- TomTom® services
- Real time traffic news
- Parking prices and availability
- Weather forecast on your journey
- Natural voice control
- Fuel prices at petrol stations
- Search for charging stations
- Quick search for points of interest
- Road safety alerts



Maintenance

Connected services are here for you – even when things go wrong. Our Intelligent Telemaintenance service monitors the key functions of your vehicle – and notifies you as soon as something needs attention.

- Vehicle status and information**
- Maintenance alerts, fuel level, average fuel consumption and mileage

Comfort and convenience

Model specific features/option	Design	GS	GS Plug-in Hybrid/Electric	Ultimate	Ultimate Plug-in Hybrid/Electric	GSe Plug-in Hybrid
Interior convenience						
Reach and rake adjustable steering	●	●	●	●	●	●
Steering wheel audio/phone/cruise controls	●	●	●	●	●	●
60/40 split-folding rear seat backs (Hatchback only)	●	●	●	●	●	●
Twin electrically adjustable/heated door mirrors	●	●	●	●	●	●
Electrically operated front and rear windows with safety autoreverse and one-touch up/down facility	●	●	●	●	●	●
Paddle shift (excludes Electric)		auto only	●	auto only	●	●
Front centre armrest with cup holder		●	●	●	●	●
Centre rear seat armrest and load-through facility		●	●	●	●	●
Frameless automatic anti-dazzle rear-view mirror		●	●	●	●	●
Flex load floor		●		●		
Wireless charger for mobile devices				●	●	●
Keyless start	●					
Keyless entry and start		●	●	●	●	●
Heating and ventilation						
Electronic climate control	●					
Dual-zone electronic climate control		●	●			
Dual-zone electronic climate control with Intelli-Air (air quality sensor)				●	●	●
Heated steering wheel and front seats		●	●	●	●	●
Heated windscreen				●	●	●
Interior seating						
Nappa Leather seat trim inserts with driver's seat memory, massage and ventilation functions (excludes Electric)				£2100*	£2100*	£2100*

*Optional at extra cost including VAT.

Comfort and convenience

Model specific features/options	Design	GS	GS Plug-in Hybrid/Electric	Ultimate	Ultimate Plug-in Hybrid/Electric	GSe Plug-in Hybrid
Interior lighting						
Illuminated vanity mirrors and rear reading lights	●	●	●	●	●	●
Ambient lighting – customisable with eight different colours		●	●	●	●	●
Interior styling						
Black headliner		●	●	●	●	●
Alloy-effect sports pedals		●	●	●	●	●
Exterior convenience						
Manually folding door mirrors	●					
Power folding door mirrors with puddle light		●	●	●	●	●
Electrically operated slide/tilt glass sunroof with blind				●**	●**	
Tow bar	£605*	£605*	£605*	£605*	£605*	£605*
Provision for spare wheel fitment – spare wheel is Retailer-fit, deletes emergency tyre inflation kit	£20*	£20*		£20*		
Power tailgate (Sports Tourer only)				●	●	●
7.4kW on-board charger – halves charging time when charging with a 7kW wallbox (Plug-in Hybrid only)			£500*		£500*	£500*

*Optional at extra cost including VAT. **Please note, delete sunroof is available as a no-cost option, please consult your Retailer.



VX_AST_33210

Ambient lighting.



VX_AST_33211

Alloy-effect sports pedals.



VX_AST_32999

Electrically operated slide/tilt glass sunroof with blind.

Versatility – Sports Tourer

The following features are available across the Astra Sports Tourer range. Specific features by model are outlined in the separate tabular information.

Intelli-Space

- 40/20/40 split-folding rear seat backs
- Easy accessible storage boxes in the boot floor accommodate tyre inflation kit and first-aid kit
- Side storage with nets
- Luggage compartment retractable cover

Additional features (petrol)

- Spare-wheel storage area
- Rear seat backs with remote easy-fold facility

Additional feature (Plug-in Hybrid/Electric)

- Special under-carpet storage space for battery, charging cable, tyre inflation kit and first-aid kit

Model specific features	Design	GS	GS Plug-in Hybrid	Ultimate	Ultimate Plug-in Hybrid	GSe Plug-in Hybrid
Interior load area						
Fixed floor with luggage restraining nets (pair)			●	●	●	●
Flex load floor with luggage restraining nets (pair)	●	●				
Rear seat load-through facility with armrest and cup holders		●	●	●	●	●
Intelli-Space load floor adjustable in two heights for flat load area. Adds additional 40 litres of load volume in lower position	●	●				



VX_ASST_33763

Intelli-Space 40/20/40 split rear seats.



VX_ASST_33255

Intelli-Space adjustable load floor.



VX_ASST_33254

Easy accessible storage boxes.

Safety and security

Model specific features	Design	GS	GS Plug-in Hybrid/Electric	Ultimate	Ultimate Plug-in Hybrid/Electric	GSe Plug-in Hybrid
Airbags						
Driver's and front passenger's airbag	●	●	●	●	●	●
Front seat side-impact and full-size curtain airbags	●	●	●	●	●	●
Braking						
In crash braking – the system automatically brakes the vehicle to help it come to a standstill after a severe collision	●	●	●	●	●	●
Hill start assist – holds the vehicle steady for two seconds on slopes with a gradient of over 3% after the brake pedal is released	●	●	●	●	●	●
Child safety						
Deactivation switch for front passenger's front and side-impact bags	●	●	●	●	●	●
ISOFIX child seat mountings – located on outer rear seats incorporating top tether mounting points. (Does not include child seat)	●	●	●	●	●	●
Security						
Remote control ultrasonic security alarm system	●	●	●	●	●	●
Locking wheel bolts for alloy wheels	●	●	●	●	●	●



Hill start assist.

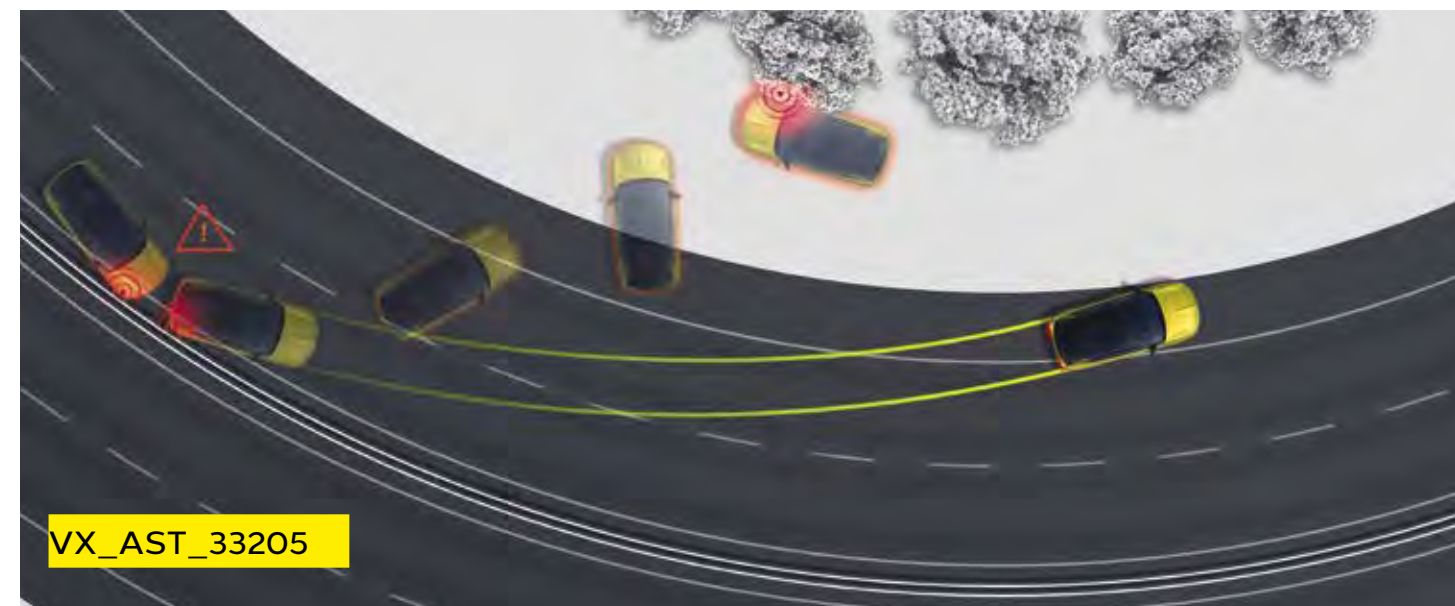

In-crash braking.



ISOFIX child seat mountings.

Styling – Hatchback

Model specific features/options	Design	GS	GS Plug-in Hybrid/Electric	Ultimate	Ultimate Plug-in Hybrid/Electric	GSe Plug-in Hybrid
Exterior styling						
Body-colour door handles	●	●	●	●	●	●
Black lower window moulding	●	●	●	●	●	●
Black-painted door mirrors	●	●	●	●	●	●
Body-colour bumpers with grained black lower front grille and rear valance panel	●					
Body-colour sports-style bumpers with high gloss black lower front grille, decor blade and rear valance panel		●	●	●	●	
Unique GSe body-colour sports-style bumpers with high gloss black lower front grille, decor blade and rear valance panel						●
Chrome-effect Griffin logo and Black vizer frame	●					
Black Griffin logo and vizer frame		●	●	●	●	●
Dark-tinted rear windows		●	●	●	●	●
Body-colour roof and rear spoiler	●	No-cost	No-cost	No-cost	No-cost	No-cost
Carbon black roof and rear spoiler**		●	●	●	●	●
18-inch bi-colour diamond-cut alloy wheels with red inserts†		£300*				

*Optional at extra cost including VAT. **Standard with Carbon Black body colour. †Not available with Electric Yellow or Cobalt Blue paints.

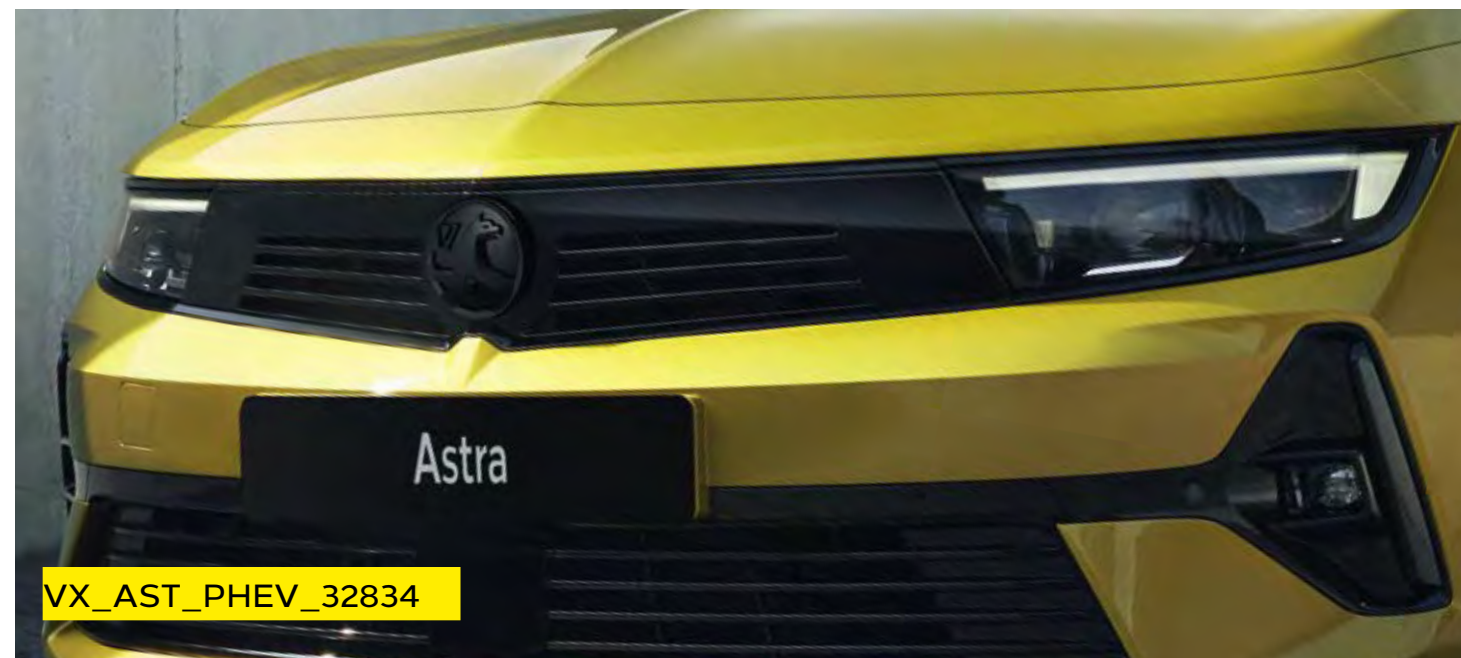

Black Griffin logo and vizer frame.



Black roof and dark-tinted rear windows.



Rear styling.

Styling – Sports Tourer

Model specific features/options	Design	GS	GS Plug-in Hybrid	Ultimate	Ultimate Plug-in Hybrid	GSe Plug-in Hybrid
Exterior styling						
Body-colour door handles	●	●	●	●	●	●
Black lower window moulding	●	●	●	●	●	●
Black-painted door mirrors	●	●	●	●	●	●
Body-colour bumpers with grained black lower front grille and rear valance panel	●					
Body-colour sports-style bumpers with high gloss black lower front grille, decor blade and rear valance panel		●	●	●	●	●
Unique GSe body-colour sports-style bumpers with high gloss black lower front grille, decor blade and rear valance panel						●
Chrome-effect Griffin logo and Black vizer frame	●					
Black Griffin logo and vizer frame		●	●	●	●	●
Dark-tinted rear windows		●	●	●	●	●
Body-colour roof and rear spoiler	●	No-cost	No-cost	No-cost	No-cost	No-cost
Carbon black roof and rear spoiler**		●	●	●	●	●
High gloss black roof rails		£200*	£200*	●	●	●

*Optional at extra cost including VAT. **Standard with Carbon Black body colour.

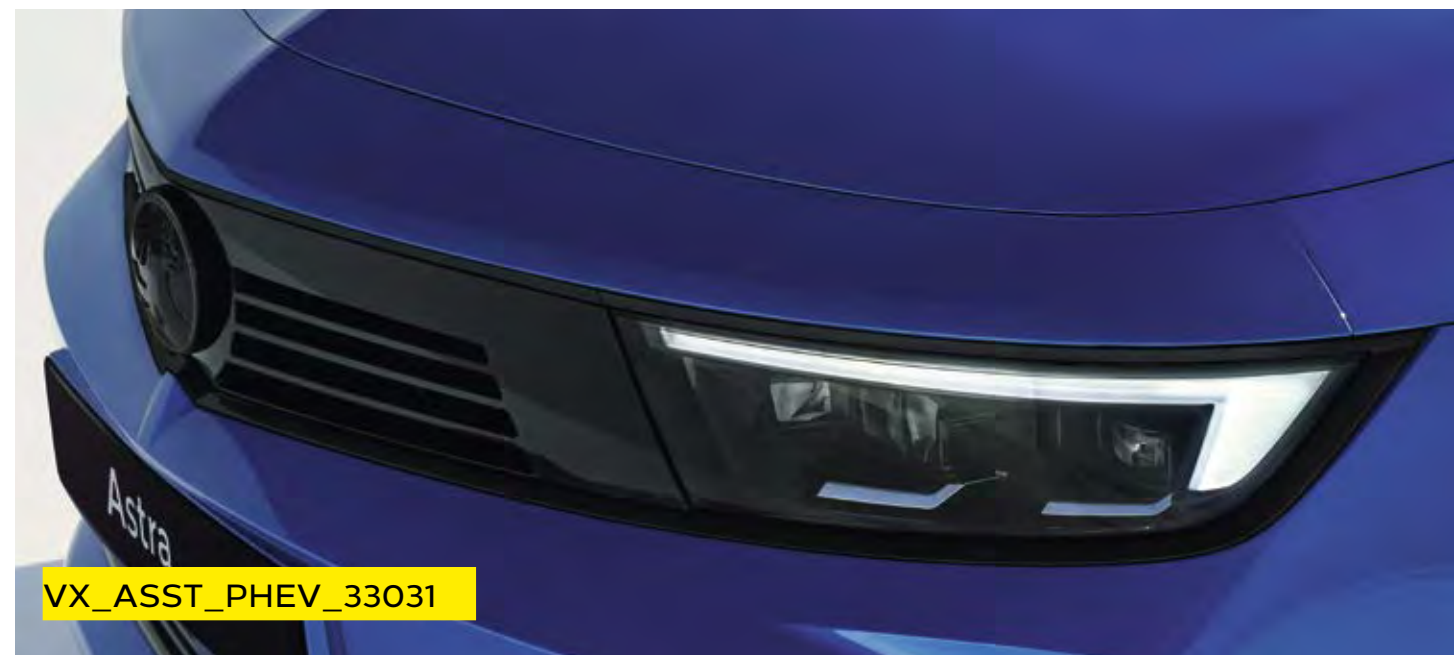

Black Griffin logo and vizer frame.



Black roof and dark-tinted rear windows.



Rear styling.

Exterior colours

Arctic White (POWP)*
Brilliant paint



VX_AST_PHEV_32844

Carbon Black (M49V)**
Two-coat metallic paint £600



VX_AST_PHEV_32850

Vulcan Grey (MOVL)**
Two-coat metallic paint £600



VX_AST_PHEV_32848

Crystal Silver (MOZR)**
Two-coat metallic paint £600



VX_AST_PHEV_32849

Crimson Red (M5PQ)**
Two-coat premium metallic paint £700



VX_AST_PHEV_32845

Electric Yellow (MORV)†
Two-coat premium metallic paint £700



VX_AST_PHEV_32847

Cobalt Blue (M6SM)**
Tri-coat premium metallic paint £700



VX_AST_PHEV_32846

The colours reproduced may vary slightly from the actual paint colour. As a result they should be used as a guide only. Your Vauxhall Retailer has a comprehensive display of our paint samples.

Please note, vehicles illustrated are not model specific and are for illustrative purposes only.

*Standard exterior paint. **Optional at extra cost including VAT. †Optional at extra cost including VAT. Not available on GSe or Sports Tourer models. ††Optional at extra cost including VAT. Not available on GSe models.

PureEnergy

Model specific features are outlined in the following pages.

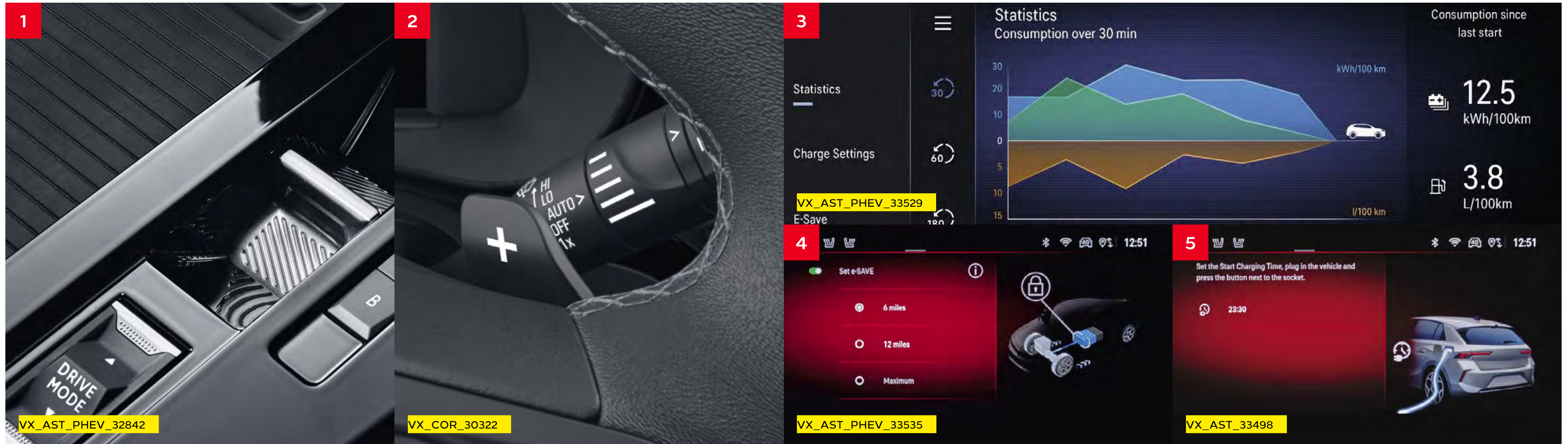

1. Electrified transmission

The e-EAT8 electrified 8-speed automatic transmission system is standard on the Astra Plug-in Hybrid and offers smooth transition between gears. It features:

- A multi-disc wet clutch, replacing the torque convertor
- Permanent electric motor that transforms electric energy into mechanical drive energy
- Electric motor installed into the gearbox and petrol engine
- Electric motor adds an additional electric power of 81.2kW (110PS) and makes a torque of 320Nm for 10 seconds

2. Paddle shift

Astra automatic Petrol and Plug-in Hybrid customers can also experience a more involving driving experience by using the paddle shift levers integrated into the steering wheel; a feature normally found on larger executive sports models.

3/4. EV information displays

All Electric/Plug-in-Hybrid-specific data is displayed in the infotainment system and can be accessed using the special 'EV' button on the infotainment system. The EV app includes the following submenus:

- Flow
- Statistics
- E-save

5. Electric vehicle services

Electric vehicle services, such as thermal preconditioning and battery charging functions, are available not just with the MyVauxhall app, but also through the infotainment system in certain cases.

PureEnergy – GSe

Model specific features are outlined in the following pages.



1. Astra GSe

GSe stands for Grand Sport Electric. Athletic good looks build on Vauxhall's bold and pure design while a driver-focused, bespoke chassis set-up complements the dynamic performance of an electrified 225PS powertrain.

2. Re-calibrated sports steering

Revised steering geometry on Astra GSe models provides increased feedback and allows the driver to more accurately judge grip levels.

3. Unique GSe chassis set-up

The Astra GSe features a bespoke chassis set up. The ride height has been lowered by 10mm with unique springs and Koni Frequency Selective Damping (FSD) dampers that adapt almost instantly to changes in road conditions and vehicle behaviour. This delivers a more agile and precise handling experience without sacrificing ride quality.

4. Unique ESP settings

Adjustments have also been made to the electronic stability program which monitors the traction control. This enables the system to respond more effectively to cope with the increase in engine power and greater dynamic driving behaviour made possible by the chassis improvements.

PureEnergy – Electric

Single-speed electronic drive selector

As the motor is an all-electric single-speed drive unit, there is no need for multiple gears. Instead, the shifter lets the driver select from the following:

- Park • Reverse • Neutral • Drive
- Braking (for increased regenerative braking)

Drive mode selector

The driver can determine the driving style by selecting one of the following modes:

- **Sport:** for a dynamic drive with a responsive throttle and the highest top speed and torque
- **Normal:** for a balanced drive that offers a compromise between performance and energy efficiency
- **ECO:** for maximum range and energy efficiency. The ECO mode deactivates all unnecessary energy-consuming features and reduces the top speed, torque and overall performance

Charging

Astra Electric is fitted with a 11kW on board charger and is also equipped with a Mode 3 cable as standard. Additional charging accessories are available at extra cost. For more details please consult your local Retailer.

The charging flap's Padlock LED lights up when the cable is correctly plugged in and locked and then acts as a user interface to show the charging status via coloured LED lights:

- **White:** welcome light that helps to light up the area, especially useful in dark conditions
- **Flashing green:** charging in progress
- **Solid green:** charging complete
- **Solid blue:** delayed charging toggled; changes to flashing green when charging commences
- **Solid red:** malfunction

The driver may also choose from two settings:

- **Immediate charging (the standard setting):** Starts charging as soon as the vehicle is docked for charging
- **Delayed charging:** This is especially useful for when cheaper electric rates are desired, e.g. charging at night. Simply enter a charging start time

Please note, EV range assumes that vehicle has been pre-conditioned prior to journey. This function can be accessed either via MyVauxhall App or by using the Multimedia Navi Pro infotainment system.

Drivetrain – Electric		
CO ₂ emissions	0g/km	
Maximum power (Sport mode)	115kW (156PS)	
Maximum torque (Sport mode)	270Nm (199lb.ft.)	
Acceleration 0–62mph	9.2 secs	
Maximum speed	105mph	
Transmission	All-electric single-speed drive unit	
Service interval	Initial inspection at 8,000 miles/1 year (whichever comes sooner). Thereafter 16,000 miles/2 years (whichever comes sooner)	
Battery		
Battery capacity	54kWh	
AC on-board charger speed	11kW	
EAER (WLTP high)*	254–258 miles	
Energy consumption (WLTP)*	14.9kWh/100km	
Battery warranty	8 years/100,000 miles/70% capacity	
Charging (Supply)	Socket	Charge Time (0–100%)
AC current – Domestic 3 pin socket (2.3kW)	Type 2	19h
AC current – Home wallbox or public charger (7kW)	Type 2	8h
AC current – Public charger (11kW)	Type 2	5h 45m
DC current – Rapid charger (100kW)	CCS	26m (20–80%)
Charging cables		11kW on-board charger
Mode 3, 3-phase 22kW cable		Standard

The Astra Electric is a battery electric vehicle requiring mains electricity for charging. Range data given has been determined according to WLTP test procedure methodology. The figures shown are intended for comparability purposes only and should only be compared to other cars tested to the same technical standard. The range you achieve under real world driving conditions will depend upon a number of factors, including but not limited to: the accessories fitted (pre and post registration); charging frequency; personal driving style; vehicle load and route characteristics; variations in weather; heating/air conditioning; pre-conditioning and battery condition. For more information, contact your local Vauxhall Retailer.

EAER = Equivalent All Electric Range. *WLTP preliminary.

PureEnergy – Plug-in Hybrid

Electrified transmission

The 8-speed electrified transmission system is standard and offers both smooth transition between gears. The 8-speed electrified gearbox includes the following content:

- Multi-disc wet clutch replaces removed torque converter
- Permanent electric motor that transforms electric energy into mechanical drive energy
- Electric motor installed into the gearbox and petrol engine
- Comes with intuitive and stylish automatic gearbox with electric shifter with shift paddles

The current driving position is indicated to the driver with a LED between:

- **R:** used for reverse driving
- **N:** used for neutral, allowing the vehicle to be moved with ignition off
- **D:** used for automatic drive, the gearbox change gears without any action from the driver
- **B button:** to switch to regenerative braking

Drive mode selector

The Drive Mode selector is positioned next to the automatic gearbox with electric shifter and enables drivers to select one of the following:

- Normal is the default Hybrid mode and offers the best of both worlds between controlled fuel consumption and on-road performance

- Sport mode, draws on the combined power of the engine and motor for a more dynamic drive
- Electric mode activates the electric motor only, for zero CO₂ emissions and complete silence
- **Engine sound enhancement:** In the Sport mode, the engine sound is amplified via the radio speakers depending on input factors such as vehicle speed, engine speed, acceleration, gear and pedal position.

Charging

- Astra Plug-in Hybrid range comes with a Mode 2 cable and a 3.7kW on-board charger as standard. Includes cable bag at no extra cost

Please note: A Mode 2 cable (standard UK socket*) would charge the vehicle in less than 8 hours.

Astra Plug-in Hybrid range charging time examples are listed showing times dependant on the various powers of charge point which the vehicle is plugged into.

Please note, EV range assumes that vehicle has been pre-conditioned prior to journey. This function can be accessed via MyVauxhall App or Infotainment system.

Preliminary data determined according to WLTP test procedure methodology. EU type approval and Certificate of Conformity are not yet available. Preliminary values may differ from official final type approval data. Charging rate depends on power source and charging cable used.

These figures were obtained using a combination of battery power and fuel. The Astra Plug-in Hybrid requires mains electricity for charging.

*WLTP Figures shown are for comparison purposes and should only be compared to the fuel consumption, CO₂ values and electric range of other cars tested to the same technical standard. The fuel consumption and electric range achieved, and CO₂ produced, in real world conditions will depend upon a number of factors including, but not limited to: the accessories fitted (pre and post registration); charging frequency; battery condition; variations in weather; driving styles and vehicle load. For more information contact your local Vauxhall Retailer.

EAER = Equivalent All Electric Range. *Only use a domestic electrical socket that has been checked by a qualified electrician and is protected by a circuit breaker adapted to the amperage of the electrical circuit. **Requires optional 7kW on board charger. †Hatchback. ††Sports Tourer.

Petrol engine	1.6 (180PS)	1.6 (225PS)
Maximum power	150PS (110kW) @ 6000rpm	180PS (133kW) @ 6000rpm
Combined power	180PS (133kW) @ 6000rpm	225PS (165kW) @ 6000rpm
Maximum torque	250Nm (184lb.ft.) @ 1750rpm	250Nm (184lb.ft.) @ 1750rpm
Combined torque	360Nm (265lb.ft.) @ 6000rpm	360Nm (265lb.ft.) @ 6000rpm
Combined CO ₂ emissions (WLTP)#	23–24g/km	25–26g/km
Combined fuel economy (WLTP)#	256 mpg (1.1 l/100km)	256 mpg (1.1 l/100km)
Combined maximum speed	140mph	146mph
0–62mph	7.7 secs	7.5 secs
Configuration	4 cylinders, 4 valves per cylinder, double overhead camshafts	
Fuel/induction system	Turbocharger. Variable Valve Timing. Common rail direct injection	
Emission compliance	Euro 6.4	
Service interval	20,000 miles or 1 year (whichever occurs sooner)	
Electric motor	1.6 (180PS)	1.6 (225PS)
Maximum power	110hp (81kW) @ 2500rpm	110hp (81kW) @ 2500rpm
Battery	1.6 (180PS)	1.6 (225PS)
Battery capacity	12.4kWh	12.4kWh
AC on-board charger speed (standard)	3.7kW	3.7kW
EAER (WLTP high)#	up to 42 miles	up to 40 miles†/up to 39 miles††
Energy consumption (WLTP combined)	16kWh/100km	15.1–15.2kWh/100km
Battery warranty	8 years/100,000 miles/70% capacity	
Charging (Supply AC current)	Socket	Charge Time (0–100%)
Domestic 3 pin socket (2.3kW)	Type 2	5h 30m
Home wallbox or public charger (3.6kW)	Type 2	3h 30m
Home wallbox or public charger (7kW)**	Type 2	1h 55m

PureEnergy – Petrol

Petrol engines	1.2 (110PS) Turbo	1.2 (130PS) Turbo
Capacity	1199cc	1199cc
Maximum power	110PS (81kW) @ 5500rpm	130PS (96kW) @ 5500rpm
Maximum torque	205Nm (151lb.ft.) @ 1750rpm	230Nm (169lb.ft.) @ 1750rpm
Configuration	3 cylinders, 4 valves per cylinder, double overhead camshafts	3 cylinders, 4 valves per cylinder, double overhead camshafts
Fuel/induction system	Turbocharger. Variable Valve Timing (VVT). Spark ignited direct injection (SIDI)	Turbocharger. Variable Valve Timing (VVT). Spark ignited direct injection (SIDI)
Emission compliance	Euro 6.4	Euro 6.4
Service interval	12,500 miles or 1 year (whichever occurs sooner)	12,500 miles or 1 year (whichever occurs sooner)

Performance, fuel economy and emissions	Performance (manufacturer's figures)		Fuel economy mpg (litres/100km)*		CO ₂ emissions g/km*		Vehicle Excise Duty*		BiK rates from – 2023/24 tax year
	Maximum speed (mph)	Acceleration 0–60mph (sec)	Combined Low	Combined High	Combined Low	Combined High	First year rate	Standard rate	
Hatchback									
1.2 (110PS) Turbo	124	10.5	52.3 (5.4)	52.3 (5.4)	123	123	£210	£180	29%
1.2 (130PS) Turbo	130	9.7	49.6 (5.7)	52.3 (5.4)	123	128	£210	£180	29%
1.2 (130PS) Turbo auto	130	9.7	48.7 (5.8)	50.4 (5.6)	125	131	£255	£180	31%
Sports Tourer									
1.2 (110PS) Turbo	124	10.8	50.4 (5.6)	50.4 (5.6)	125	125	£210	£180	30%
1.2 (130PS) Turbo	130	10.0	48.7 (5.8)	50.4 (5.6)	126	131	£210	£180	30%
1.2 (130PS) Turbo auto	130	9.9	47.9 (5.9)	49.6 (5.7)	128	134	£255	£180	30%

*Figures shown are for comparison purposes and should only be compared to the fuel consumption and CO₂ values of other cars tested to the same technical standard. The fuel consumption achieved, and CO₂ produced, in real world conditions will depend upon a number of factors including, but not limited to: the accessories fitted (pre and post registration); variations in weather; driving styles and vehicle load. The WLTP (Worldwide Harmonised Light Vehicles Test Procedure) is used to measure fuel consumption and CO₂ figures. The CO₂ figures display a range to reflect the highest value for the highest emitting version with all available options added, through to a minimum value to represent the lowest emitting version in standard specification.

*Correct at time of publication.

Specifications

Transmission

Six-speed manual gearbox

Petrol engines: 1.2 (110/130PS) Turbo models

8-speed automatic transmission

Available on the 1.2 (130PS) Turbo, the 8-speed automatic transmission enables increased drive comfort and improved fuel economy. The automatic gear lever has been replaced by an ergonomic e-toggle in harmony with the interior design. The new e-toggle is standard for combustion engine and Plug-in Hybrid.

The current driving position is indicated to the driver with a LED between:

- **R:** used for reverse driving
- **N:** used for neutral, allowing the vehicle to be moved with ignition off
- **D:** used for automatic drive, the gearbox change gears without any action from the driver
- **M button:** Manual shifting mode for combustion engines. The driver changes gears with the shift paddles on steering wheel

The driver can also select between three different driving modes, Sport, Normal and Eco, which offer several enhancements to the driving experience.

Steering

- Power-assisted steering
- Turning circle (wall-to-wall):
 - 10.51m (34.5ft.) Hatchback
 - 10.71m (35.1ft.) Sports Tourer

Tank Capacities

- 52 litres (11.4 gallons) – Petrol
- 42 litres (9.2 gallons) – Plug-in Hybrid

Braking and stability

- Electronic Stability Programme (ESP) – ESP monitors many different inputs to determine when the car starts to lose traction, it can then immediately respond by varying the brake pressure between up to three wheels and adjust the engine output to help correct the loss of traction and improve stability
- Cornering brake control
- Straight line stability control
- Rollover mitigation
- Drag torque control – Maintain stability on slippery roads when lifting off the accelerator or changing gear
- Hill start assist
- Anti-lock Braking System (ABS)
- Emergency brake assist
- Fading brake support
- Electronic brakeforce distribution
- Adaptive brake lights

Suspension

Front: Independent. Decoupled MacPherson struts with gas-pressure dampers and coil springs. Anti-roll bar.

Rear: Compound crank with coil springs and gas-pressure dampers.

GSe models

Ride height lowered by 10mm.

Front: Independent Decoupled MacPherson struts with Koni FSD (Frequency Selective Damping) oil-filled dampers and revised springs. Anti-roll bar.

Rear: Compound crank with coil springs and Koni FSD (Frequency Selective Damping) oil-filled dampers and revised rear springs.

Start/Stop technology

Astra's feature Start/Stop technology offering real benefits by improving fuel economy and reducing CO₂ emissions, particularly in town. It does this by automatically stopping the engine when you come to a standstill, and then restarting as you prepare to move off.

Before automatically stopping the engine a number of system checks are carried out to ensure that it is both safe and practical to do so. To ensure safety, the driver must depress the clutch pedal, shift in to neutral, and then release the clutch pedal.

System checks carried out before Auto Stop activates include:

- Start/Stop system is not manually deactivated via the facia button
- Sufficient brake vacuum is available to prevent the car rolling down an incline
- Battery is in good condition and charged
- Outside air temperature and engine temperature are above specified minima
- Electronic climate control (where fitted) is not in maximum heating or maximum cooling mode

If all of these conditions are satisfied then the vehicle will Auto Stop.

When you are ready to pull away from standstill, Auto Restart is activated by depressing the clutch pedal.

Whilst at a standstill the vehicle is continually monitored. If necessary, the engine will automatically be restarted. Conditions that would initiate an Auto Restart include:

- Low battery level
- Brake vacuum below specified minimum
- Start/Stop system is manually deactivated
- Stationary for 5.5 minutes

Dimensions and capacities

All measurements in mm (inches) unless stated otherwise.

Loadspace dimensions	Hatchback	Sports Tourer
Load floor length (rear seats folded)	1589 (62.5)	1850 (72.8)
Load floor length (behind rear seats)	795 (31.3) 770 (30.3)**	1026 (40.3) 1018 (40.0)**
Load area width	1020 (40.2)	1032 (40.6)
Load area height	599 (23.5) 601 (23.6)**	599 (23.5) 601 (23.6)**
Tailgate aperture width (maximum)	1019 (40.1)	tba
Tailgate aperture height	526 (20.7)	482 (18.9)

Luggage capacities* – Litres (cu.ft.)	Hatchback	Sports Tourer
Rear seat up (under luggage compartment cover)	422 (14.9) 352 (12.4)**	597 (21.0) 516 (18.2)**
Rear seat down (measured to roof)	1339 (47.2) 1268 (44.7)**	1634 (57.7) 1553 (54.8)**

Weights and towing data (kg)	Gross vehicle weight		Max. towing weights. Trailer with brakes (without brakes)	
	Hatchback	Sports Tourer	Hatchback	Sports Tourer
1.2 (110PS) Turbo	1820	1870	1250 (660)	1200 (680)
1.2 (130PS) Turbo	1840	1880	1250 (660)	1200 (690)
1.2 (130PS) Turbo auto	1880	1900	1400 (680) [†] / 1200 (680) ^{††}	1400 (680) [†] / 1200 (680) ^{††}
1.6 (180PS) Turbo/Electric auto	2150	2170	1450 (750)	1400 (750)
1.6 (225PS) Turbo/Electric auto	2150	2170	1450 (750)	1400 (750)
Electric Propulsion (156PS) auto	2100	-	-	-

Hatchback



Sports Tourer



Please note, vehicles illustrated are not model specific and are for illustrative purposes only.

Please note: **Gross vehicle weight** is the total permissible weight of the vehicle including passengers and their luggage. The **maximum roof rack loading** should not exceed 75kg. The **maximum towing weights** are based on the ability of the car, with two occupants of 75kg each, to restart on a 12% gradient, which is approximately 1 in 8.3, at sea level. The permitted trailer load applies up to the specified incline and up to an altitude of 1000 metres above sea level. The permissible gross train weight decreases by 10% for every 1000 metres of additional altitude. At altitudes above 1500 metres, the engine output may drop with a corresponding reduction in towing capability. Any extra weight, such as luggage or additional passengers, should be deducted from the maximum towing weight. With a trailer fully loaded, maximum noseweight should not exceed 75kg. Always fit Vauxhall towing attachments and accessories available from your Vauxhall Retailer. They are designed specifically for Vauxhall models and carry a 12-month guarantee.

*Measured using the ECIE method. When a spare wheel is specified loadspace capacity is reduced due to a raised luggage compartment floor. **Plug-in Hybrid. [†]Factory-fit. ^{††}Retailer-fit.

Company car driver and fleet information

Benefit in kind company car taxation*

The car benefit charge will be the car's list price (including VAT, options and accessories fitted, delivery to Retailer and number plates, but excluding Vehicle Excise Duty and new vehicle first registration fee) multiplied by the percentage charge for the CO₂ emissions band in which the car falls (see table opposite). Multiply this figure by your personal income tax rate (20%** for Basic Rate, 40%** for Higher Rate) to calculate your annual benefit in kind tax liability.

Generic example:

ELECTRIC vehicle: 0g/km CO₂

On-the-road RRP	£27,305.00
Deduct: Vehicle Excise Duty	£0.00
New vehicle first registration fee	-£55.00
Effective list price	£27,250.00
Add: Optional two-coat metallic paint	£600.00
List price for tax purposes (P11D value)	£27,850.00
Car benefit charge 2023–24 tax year (2%)	£557.00
Benefit in kind tax liability	
Basic Rate (20%) tax payer	£111.40
Higher Rate (40%) tax payer	£222.80

*Please note this Price Guide provides taxation information as a guide only. Vauxhall does not provide taxation guidance. Drivers should always take professional advice on their own tax position.
 **Excludes residents of Scotland.

BiK for Scottish Residents

Effective 6 April 2018 the Scottish Government have introduced their own BiK taxation structure. This only applies to Company Car Drivers that are Scottish taxpayers. HMRC will determine whether or not an individual is a Scottish taxpayer based on where their main place of residence is.

The BiK rates for Scotland are:

- Over £12,570 – £14,732 Starter Rate 19%
- Over £14,732 – £25,688 Basic Rate 20%
- Over £25,688 – £43,662 Intermediate Rate 21%
- Over £43,662 – £150,000 Higher Rate 41%
- Above £150,000 Top Rate 46%

CO ₂ emissions (g/km)	Percentage of cars price to be taxed 2023–24 tax year
Up to 50	14%
51 – 54	15%
55 – 59	16%
60 – 64	17%
65 – 69	18%
70 – 74	19%
75 – 79	20%
80 – 84	21%
85 – 89	22%
90 – 94	23%
95 – 99	24%
100 – 104	25%
105 – 109	26%
110 – 114	27%
115 – 119	28%
120 – 124	29%
125 – 129	30%
130 – 134	31%
135 – 139	32%
140 – 144	33%
145 – 149	34%
150 – 154	35%
155 – 159	36%
160 – 164	37%
165 – 169	37%
170+	37%

CO ₂ emissions (g/km)	Electric range (miles)	Percentage of cars price to be taxed 2023–24 tax year
0	–	2%
1 – 50	130+	2%
1 – 50	70 – 129	5%
1 – 50	40 – 69	8%
1 – 50	30 – 39	12%
1 – 50	<30	14%

To calculate your own personal liability, search: **Vauxhall BiK**, or click the link below:
[Vauxhall BiK Tool](#)

Fleet Toolbox

Discover the facts in our online Toolbox for both Company Car Drivers and Fleet Decision Makers. The Fleet Toolbox has a host of useful calculators, comparators, interactive listings and information.

Search Vauxhall Fleet Tools or click the link below:
[Vauxhall Fleet Tool Box](#)

Contact Vauxhall Fleet

Please contact one of our dedicated sales teams who will be happy to help with your particular enquiry.

Fleet Decision Makers

Depending on the size of your fleet of vehicles, we have a dedicated team to handle your enquiries. The lines are open Monday to Friday excluding Bank Holidays.

1–24 vehicles

Call: 0203 885 4560 (8:30am–5:00pm)

Email: enquiries@stellantis-fleet.co.uk

50+ vehicles

Call: 0203 885 4562 (8:30am–5:00pm)

Email: enquiries@vauxhallfleet.co.uk

Special Vehicles (Police, Fire and Ambulance)

Call: 01582 409999

Email: psvo@stellantis.com

For more information visit vauxhall.co.uk/fleet

Further information

On-the-road prices

To eliminate uncertainty about hidden costs when buying a new car, Vauxhall publishes on-the-road recommended retail prices (RRP) and these are shown in the pricing tables within this price guide. These prices include VAT, number plates and delivery to Retailer of £900.00 (including £150.00 VAT), 12 months' Government Vehicle Excise Duty (see opposite for details) and the DVLA new vehicle first registration fee of £55.00.*

Please note: The on-the-road recommended retail price (RRP) does not include fuel supplied by the Retailer, motor insurance or any other goods or services supplied by agreement between the Retailer and the customer.

Price protection

Order a new Vauxhall for build in the current model year (as confirmed by your Retailer) for delivery no more than three months in advance and the price you are quoted is the price you pay. This is irrespective of any subsequent price rises between placing your order and delivery of your new car, but you must take delivery as soon as the car is available.

Please note: Vauxhall Motors Limited is not liable for price adjustments caused by Government changes in the rate of VAT (currently 20%), Vehicle Excise Duty, DVLA new vehicle first registration fee or by any other applicable legislation or regulations.

LEASYS

Leasys UK

Leasys is the proud Business Contract Hire partner of Vauxhall and consequently, can provide quick vehicle delivery to keep your business mobile.

Specialised in Medium to Long-Term Leasing options and Fleet Management solutions for businesses of all sizes, [Leasys](#) lead mobility by offering sustainable and innovative solutions designed around customers, for a best-in-class experience. Their team of experts can personally support you and provide dedicated consultation.

[Leasys](#) is equally owned by Stellantis and Crédit Agricole Consumer Finance and is a member of the British Vehicle Rental and Leasing Association (BVRLA).

For further information, please contact your local Vauxhall Retailer or visit [leasys.com/uk](#)

Vehicle Excise Duty

The amount of Vehicle Excise Duty (road fund licence) payable on new cars varies depending on the level of carbon dioxide (CO₂) emissions produced by the vehicle. CO₂ emissions are measured in grams per kilometre (g/km) travelled and divided into 13 charging bands shown in the table opposite.

A 'first year rate' of Vehicle Excise Duty is payable on all new cars and in subsequent years the amount payable reverts to the 'standard rate'. Also, for vehicles with a list price over £40,000, including factory-fitted options, an additional £390 is payable for the first five years of standard rate payments.

Vehicle Excise Duty*

Band	CO ₂ emissions in grams per kilometre	First year rate Petrol	Standard rate Petrol	Standard rate Hybrid	Standard rate Electric
A	0	£0	£0	£0	£0
B	1 – 50	£10	£180	£0	–
C	51 – 75	£30	£180	£20	–
D	76 – 90	£130	£180	£120	–
E	91 – 100	£165	£180	£155	–
F	101 – 110	£185	£180	£175	–
G	111 – 130	£210	£180	£200	–
H	131 – 150	£255	£180	£245	–
I	151 – 170	£645	£180	£635	–
J	171 – 190	£1,040	£180	£1,030	–
K	191 – 225	£1,565	£180	£1,555	–
L	226 – 255	£2,220	£180	£2,010	–
M	Over 255	£2,605	£180	£2,595	–

*Correct at time of issue.

Owners information

Customer Care Commitment

For added peace of mind, Vauxhall has an innovative Customer Care Commitment that offers the following:

- Three-year vehicle warranty consisting of a one-year/unlimited mileage manufacturer's warranty and a second and third year manufacturer's warranty with a 60,000 miles limitation
- Vauxhall Assistance for 12 months from first registration
- Six years' body panel anti-perforation warranty

Please note: Warranty is only available on vehicles sourced from Vauxhall Motors Limited. Terms and conditions apply – please see your Vauxhall Retailer for details.

Vauxhall Assistance

Vauxhall Assistance is provided automatically with every new Vauxhall for 12 months from first registration and covers everything from accident assistance, roadside recovery and 'at home' service to flat tyres. For even more peace of mind, on fully electric models, the cover is extended* to 3 years. Even more reason for you to stay calm and let us take care of everything should the need arise. With Vauxhall Assistance help is literally just a free** phone call away, 24 hours a day, 365 days a year!

Protecting the environment

Vauxhall's commitment to the environment is demonstrated by our products' many environmental awards. For even more information on Vauxhall's efforts to achieve an environmentally sustainable future, and how to dispose of your end-of-life vehicle, see [vauxhall.co.uk/recycling](https://www.vauxhall.co.uk/recycling)

In the event of an accident

Vauxhall Accident Management helps keep you mobile following an accident. Benefits include vehicle recovery, Vauxhall-approved repairs and contacting your insurer. For more details, visit [vauxhall.co.uk/AccidentManagement](https://www.vauxhall.co.uk/AccidentManagement)

Vauxhall Flexcare – Service Plans and Extended Warranty

Designed for your peace of mind. A collection of extended warranty and service plans to match the way you drive.

Extended Warranty

An extended warranty for your Vauxhall offers you similar cover for material or manufacturing defects beyond the original warranty period on the vehicle. By choosing an official Vauxhall Extended Warranty, we guarantee that any repairs you need are carried out by Vauxhall trained technicians – using genuine Vauxhall parts.

Service Plans

There's no need to worry about budgeting for your next service. Simply take out a Vauxhall Fixed Price Service Care Plan. You can then focus on the more important things in life, knowing your servicing costs are taken care of. Why choose a Vauxhall Fixed Price Service Care Plan?

- Flexible to suit your needs
- Locked-in price for the duration of your plan
- Make budgeting easier with affordable monthly payments
- Brake fluid change and MOTs are available as an additional cost

For more information, click on the link below or call us on **0345 600 2065**

See [vauxhall.co.uk/discover/here-for-you.html](https://www.vauxhall.co.uk/discover/here-for-you.html)

Vauxhall Service Club

Vauxhall Service Club is available for all Vauxhall owners, and it's free to join. Members benefit from the following:

- 15% off Vauxhall Approved Accessories
- Vauxhall's aged 2-3 Years = 15% off parts and labour
- Vauxhall's aged over 3 Years = 25% off parts and labour
- Half price MOT's (NI excluded)
- Free pre-MOT test inspection (NI only)
- Access to the Vauxhall Accident Management Programme
- Online service booking available 24/7 with servicing appointments available within 3 days – [Book Online](#)
- Collection and delivery/onward mobility options
- Complimentary 'Wash and Vac' with all routine services^{††}
- Vauxhall trained technicians
- Genuine Vauxhall parts
- Minimum 12 months warranty on parts and labour
- Regular newsletters with exclusive offers, discounts and competitions

Terms and conditions apply. To join visit: [vauxhall.co.uk/serviceclub](https://www.vauxhall.co.uk/serviceclub)

Vauxhall Insurance with added reassurance

Comprehensive cover – Summary of benefits

- Competitive premiums
- Repairs by a Vauxhall-trained technician
- Genuine Vauxhall parts, guaranteed for five years when we repair your car within our Approved Repairer Network
- Free courtesy car as standard when using an Approved Repairer[‡]
- 24 hour claims helpline
- Personal Accident benefit
- Cover for audio equipment
- Windscreen cover

Call for a quote on **0330 678 1130^{††}**

Vauxhall Accessories

From the small things that make life easier to the big things that make life exciting - personalise your Vauxhall with Vauxhall Accessories. So what are you looking for? A device holder, roof box, or even splash guards? Whatever it is we've got the solution for you. With our huge accessory range, all tailor-made for your Vauxhall and come with a full year's warranty. For further details visit your local Retailer or see [vauxhall.co.uk/owners/accessories.html](https://www.vauxhall.co.uk/owners/accessories.html)

For more product information

For further information on the Vauxhall range or location of your nearest Vauxhall Retailer please call **0800 026 0034**. Alternatively, details can be found on our website at [vauxhall.co.uk](https://www.vauxhall.co.uk)

VAUXHALL

For more information call **0800 026 0034**

For Fleet enquiries call **0203 476 2268**

Discover the full Vauxhall range at **[vauxhall.co.uk](https://www.vauxhall.co.uk)**

Join us online

The invoice price, including delivery to Retailer, factory-fitted options, accessories fitted by the Retailer and number plates, is subject to VAT. Some feature descriptions in this guide may refer to, and some illustrations may show, optional equipment not included in the standard delivery. The information contained in this guide was accurate at the time of publication. We reserve the right to make changes in design and equipment. Please note that Vauxhall Retailers are not the agents of Vauxhall Motors Limited and are not authorised to bind Vauxhall Motors Limited by any specific or implied undertaking or representation. It is advisable to ensure that your motor insurance policy provides adequate cover for additional fitted options and accessories. The colours in this guide are only approximate actual colours. Illustrated optional equipment is available at extra charge. Availability, technical features and equipment provided on our vehicles can vary by model. For precise information on the equipment provided on our vehicles, please contact your local Vauxhall Retailer.