

# Movano and Vivaro

2008 Edition 2

Passenger Carriers





*Model illustrated features optional front passengers' twin airbag.*

## VIVARO PASSENGER CARRIERS

Based on the standard roof model that helped Vivaro win 'Van of the Year 2006' at the *Professional Van and Light Truck* awards and 'Best Medium Van 2007' at the *Van Fleet World* awards, Vivaro passenger carriers offer practical transport solutions for a variety of applications. Whether you choose the Vivaro 9-seat Combi – available in short and long wheelbase – or the 12-seat Minibus, all models provide spacious travel with high levels of passenger comfort, access and safety.



For operators, Vivaro offers dynamic style and an ergonomically-efficient cabin, with a six-way adjustable driver's seat and a quality stereo radio/CD player for day-long comfort. A driver's airbag and Anti-lock Braking System (ABS) are all standard. And running costs are low, thanks to a choice of efficient common rail turbo diesel engines, a standard six-speed gearbox and 18,000 mile/one-year service intervals – with a three-year/100,000 mile warranty for total peace of mind.

**The facts**

- Choice of two common rail turbo diesel engines: 2.0CDTI 16v (90PS/240Nm), 2.0CDTI 16v (115PS/290Nm)
- Front-wheel drive configuration for easy passenger access
- Six-speed manual gearbox
- Inertia-reel lap and diagonal seatbelts
- Anti-lock Braking System (ABS)
- Electronic engine deadlock immobiliser



3-year/100,000 mile warranty on base vehicle



Driver's airbag



Anti-Lock Braking System



18,000 mile/1-year service intervals

 Vivaro SWB 9-seat Combi.

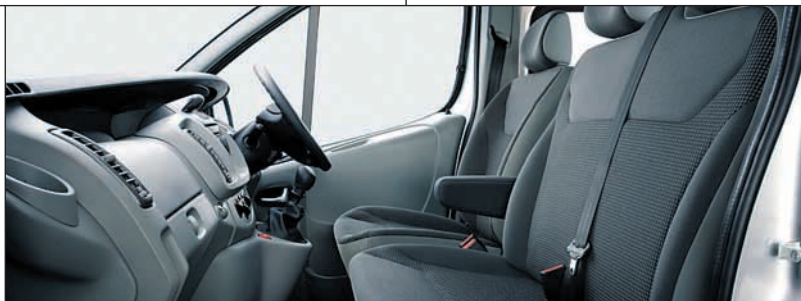



*The Vivaro Combi second-row nearside seat can be folded forward for easy access to the third-row seating. LWB model illustrated features optional sliding windows in nearside and offside sliding side-access doors and Cerise Red two-coat pearlescent paint available at extra cost. Seat trim may vary from that illustrated.*

## VIVARO 9-SEAT COMBI

Perfect for hotels, businesses, airports and hire companies, Vivaro Combi is one of the most versatile vehicles around. Available in a choice of short or long wheelbase models, it can be transformed easily and quickly from a spacious nine seater to a six seater with added luggage capacity, without removing any seats from the vehicle.

Designed to ensure long-distance comfort for every rear seat passenger, Vivaro Combi features full-length headlining and half-height panelling as standard. Twin sliding side-access doors and passenger assist handles ensure easy access from both sides of the vehicle. The 60/40 split-folding second-row seat back makes entry and exit simple and the easy-to-operate 'stow and fold' third-row seats create valuable additional luggage space.

Please see pages 16/17 for more details of Vivaro Combi specification and options.



Both models feature a high-lift tailgate, whilst the long wheelbase version also includes a removable luggage cover.

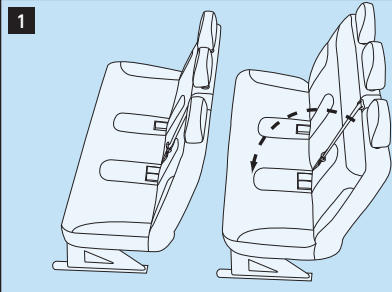

Combi's 'stow and fold' third-row seats [1-3] convert the 9-seat Combi into a six seater with additional luggage space, without having to remove any seats from the vehicle.

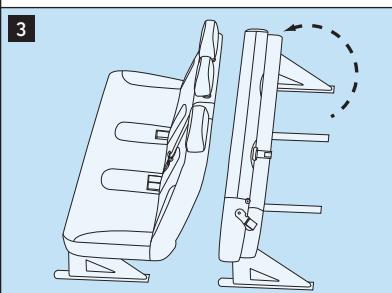
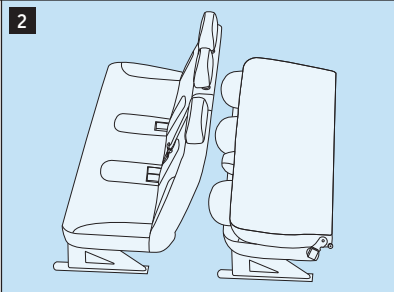

Seat trim may vary from that illustrated.

## Vivaro 9-seat Combi

Interior dimensions mm (inches)		SWB	LWB
Legroom (at knee)	- second-row	298 (11.7)	
	- third-row	230 (9.1)	
Width at elbow level	- second-row	1606 (63.2)	
	- third-row	1660 (65.3)	
Interior height – load area		1300 (51.2) -	1340 (52.8)
Load area length	- floor level	700 (27.6)	1100 (43.3)
	- to upper back rest	430 (16.9)	830 (32.7)
	- folded rear bench (maximum)	970 (38.2)	1370 (53.9)
Interior volumes cu.m (cu.ft.)			
Load area volume	- 9-seat (with luggage cover)	N/A	1.1 (38.8)
	- 9-seat (without luggage cover)	1.2 (42.4)	2.1 (74.2)
	- 9-seat (folded rear bench)	2.5 (88.3)	3.5 (123.6)







*Vivaro 12-seat Minibus provides ample space for passengers and luggage. Model illustrated features optional Adria two-coat pearlescent paint.*

## VIVARO 12-SEAT MINIBUS

Offering additional seats for a wider range of courtesy and business transport applications, the Vivaro 12-seat Minibus matches smart new looks with highly versatile passenger-carrying potential. Comfort, driveability and low operating costs are all high on the agenda.

Whether you're in the front or the rear seats, you can look forward to complete passenger comfort. A six-way adjustable driver's seat and dual front passengers' bench seat are matched with six fixed, individual second and third-row seats plus a further three removable seats in the fourth-row. Full-height side mouldings, saloon lighting and a full-length soft-trimmed headlining are standard. The bonded, rear safety glass is tinted and two top sliding side windows provide added rear ventilation.

▶ Digital tachograph\*.

*\*Tachographs became compulsory on any minibus with 10 seats or more used for commercial purposes from 11 April 2007. Exemptions apply, please contact the Commercial Vehicle specialist at your Vauxhall retailer for further details.*



▲ ▼ Fourth-row seats are mounted on aluminium rails with 'Quiklok' quick-release fittings for easy removal when extra cargo capacity is required.



Seat trim may vary from that illustrated.



Please see pages 18/19 for more details of Vivaro Minibus specification and options.





*Model illustrated features  
optional digital tachograph.*

## MOVANO PASSENGER CARRIERS

When you need a big passenger carrier, choose Movano. With a choice of 6- or 9-seat Combi models and 15-, 16- or 17-seat Minibuses it offers huge versatility for school or executive transport. For added peace of mind all seats and mountings are tested to passenger car (M1) standards.



The multi-award winning Movano combines high levels of passenger comfort and access with excellent safety and security features – including a driver’s airbag, all-round disc brakes and Anti-lock Braking System (ABS). For maximum economy and excellent performance, the choice of three 2.5CDTI 16v common rail turbo diesel engines are matched with a six-speed manual gearbox (or optional Tecshift transmission). And 18,000 mile/one-year service intervals and a three-year/100,000 mile base vehicle warranty ensure plenty of operator benefits too.

**The facts**

- Choice of three common rail turbo diesel engines: 2.5CDTI 16v (100PS/ 260Nm), 2.5CDTI 16v (120PS/300Nm), 2.5CDTI 16v (146PS/320Nm)
- Front-wheel drive configuration for easy passenger access
- Six-speed manual gearbox
- Stereo radio/CD player
- Optional six-speed Tecshift transmission on most models
- Inertia-reel lap and diagonal seatbelts with M1 Type approval for rear seatbelt anchorages
- ABS with Electronic Brakeforce Distribution (EBD)



▲ Movano SWB 9-seat Combi.



3-year/100,000 mile warranty on base vehicle



Driver's airbag



18,000 mile/1-year service intervals



*Above left: Movano MWB high roof 6-seat semi-glazed Combi.  
Above right: Movano SWB standard roof 9-seat Combi.*

## MOVANO 6- AND 9-SEAT COMBI

The Combi models reinforce Movano's 'seriously big' credentials as a consummate carrier for passengers and their luggage. Available in two wheelbases with different roof heights, Movano can be further specified in numerous configurations to suit a wide range of applications.



With fixed seating for six or nine occupants, in both short and medium wheelbase models, Movano Combi allows you to tailor people and luggage capacity – up to 8 cu.m. – to your exact needs. Passenger safety is a priority of course, with inertia-reel lap and diagonal seatbelts and padded head restraints for every seat. Wide seats with good leg and shoulder room ensure high comfort levels. And easy access is assured through wide-opening twin rear doors and a single sliding door on the nearside.

Please see pages 20/21 for more details of Movano Combi models specification and options.



▶ Spacious and comfortable seating in three rows.

▲ SWB standard roof models feature soft-trimmed headlining and full-height interior side-panelling.



▼ Eight-way adjustable driver's seat with armrest.



▲ MWB high roof models have an untrimmed load area, giving operators the opportunity to add rear racking or extra storage to suit their own particular applications.

### Movano Combi

Interior dimensions mm (inches)	SWB	MWB
Legroom (at knee) - second/third-row	285 (11.2)	
Width at elbow level - second-row	1784 (70.2)	
- third-row	1757 (69.2) - 1922 (75.7)	
Interior height - to roof trim/cross member	1670 (65.7)	1912 (75.3)
Load area length - 6-seat	1891 (74.4)	2391 (94.1)
- 9-seat	1145 (45.1)	1645 (64.8)
Interior volumes cu.m (cu.ft.)		
Load area volume - 6-seat	5.2 (183.6)	8.0 (282.5)
Load area volume - 9-seat	3.0 (105.9)	5.3 (187.2)



## MOVANO 15- AND 16-SEAT MINIBUSES

Finished to a particularly high standard, the factory-prepared Movano 15- and 16-seat Minibuses are ideal for business, education and private hire applications. The high roof, long wheelbase configuration means plenty of light and space, while high levels of equipment ensure comfort, safety and security.



Both 15- and 16-seat models provide a comfortable travelling environment, with a soft-trimmed headlining, opening side windows and staggered rear seats for greater shoulder-room. A central gangway, accessed from a single rear door and sliding side-access door – with automatically extending sidestep and assist rails – mean easy passenger access. And safety features include digital tachograph\*, airbags for the driver and front passengers, emergency window hammers, a roof-mounted emergency exit and M1 rear seatbelt approval.



*\*Tachographs become compulsory on any minibus with 10 seats or more used for commercial purposes from 11 April 2007. Exemptions apply, please contact the Commercial Vehicle specialist at your Vauxhall retailer for further details.*

▲ 15-seat models come with an internally mounted spare wheel.



▲ Staggered seats provide more shoulder room.

▼ For easy access, Movano Minibuses feature raised seating with a central gangway and lighting to each seat row. Both models also feature an automatically extending/retracting sidestep and passenger assist rails.



◀ ▲ Optional luggage racks, available at no extra cost (in lieu of seating).

*Please see page 22/23 for more details of Movano 15/16-seat Minibus specification and options.*





## MOVANO 17-SEAT MINIBUS

When you need serious people capacity, the Movano 17 seater more than fits the bill. Modern styling with long wheelbase, high roof space and a tough Movano chassis combines with powerful diesel engines to make light work of heavyweight passenger requirements.



With three people up front and 14 individual fixed seats in the rear, the Movano 17 seater pushes people carrier capability to the maximum. Yet it remains easy to drive with little compromise in passenger comfort. Every seat has attractive cloth trim, an open head restraint and a full lap and diagonal seatbelt. Easy passenger access is assured through wide-opening rear doors and a single sliding side-access door with a low sidestep. Luggage and equipment can be stored under the individual rear seats. And full-height, wipe-clean interior mouldings, and a slip-resistant floor add further comfort, convenience and safety.

▶ Optional six-speed Tecshift transmission.

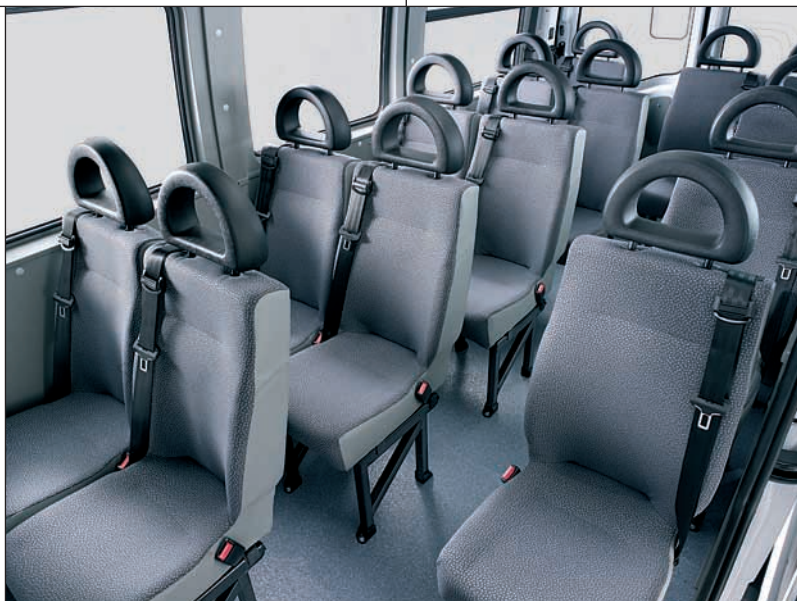

- PSV compliance
- M1 rear seatbelt Type Approval
- Automatic door locking at speeds of over 4mph
- Digital tachograph models available\*

*\*Tachographs became compulsory on any minibus with 10 seats or more used for commercial purposes from 11 April 2007. Exemptions apply, please contact the Commercial Vehicle specialist at your Vauxhall retailer for further details.*

*Please see page 22/23 for more details of Movano 17-seater Minibus specification and options.*



◀ Sunblinds illustrated are not part of standard specification, please consult your retailer for more information.

▶ Sunroof illustrated is not part of standard specification, please consult your retailer for more information.



## SWB 9-seat Combi

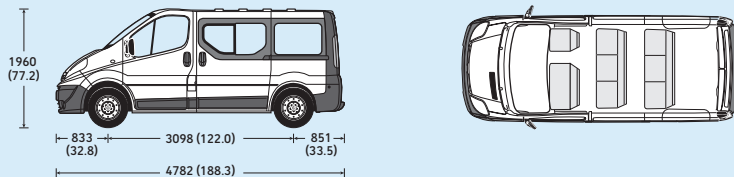

## LWB 9-seat Combi

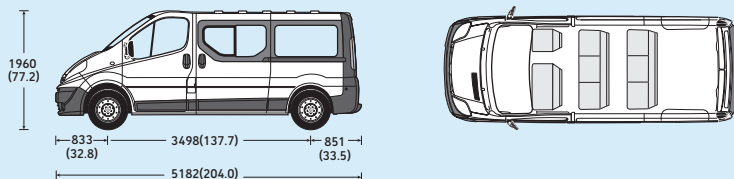

Measurements are shown in millimetres (inches). All heights are shown unladen.

## Safety and security

- Driver's airbag
- Pyrotechnic body-lock front seatbelt pretensioners
- Inertia-reel lap and diagonal seatbelts
- Anti-lock Braking System (ABS) with Electronic Brakeforce Distribution (EBD)
- Emergency Brake Assist (EBA)
- Front door side-impact protection beams
- Padded head restraints
- Remote control central deadlocking
- Electric engine deadlock immobiliser

## Interior features

- Facia-mounted gear lever
- Steering column adjustable for reach
- Rev counter
- Six-way adjustable driver's seat
- Dual front passengers' bench seat
- Punch cloth seat trim
- CD 30 MP3 stereo radio/CD with MP3 format and remote multi-function display
- Full-length soft-trimmed headlining
- Air-blend heater with four-speed fan
- Rubber floor covering
- Passenger assist grab handles
- Cab and saloon lighting
- Second-row nearside seat foldable for access to third-row seating
- Third-row bench seat with fold and stow facility
- Half-height interior side panelling

## Exterior features

- Tinted glass
- Electrically operated front windows
- Electrically adjustable/heated door mirrors
- Nearside and offside sliding side-access doors
- Fixed side windows fitted to nearside and offside sliding doors
- Tailgate with heated window and wash/wipe facility
- High level brake light
- Body side-protection mouldings

**Please note:** Full specification details for the Vivaro range appear in the Vivaro brochure available from your Vauxhall retailer or Lo-Call 0845 600 1500.

## Vauxhall Assistance and warranties\*

Every Vivaro comes with:

- A one-year unlimited mileage manufacturer's warranty
- Second and third year no-fee customer option warranty up to 100,000 miles from date of first registration
- Vauxhall Assistance for 12 months from date of first registration
- Six-year body panel anti-perforation warranty

\* = Warranty is only available on vehicles sourced from Vauxhall Motors Ltd. Terms and conditions apply – please see your Vauxhall retailer for details.

## Optional features at extra cost

- Vision Pack: comprising rain-sensitive windscreen wipers, front fog lights and selective door locking
- Front passengers' twin airbag
- Electronic Stability Programme-plus (ESP-plus)
- Remote control ultrasonic security alarm system
- Driver's seat with lumbar adjustment and armrest
- Driver's seat and single front passenger's seat with lumbar adjustment and armrest
- Sliding side windows to nearside and offside side doors
- Air conditioning (front only)
- Air conditioning (front and rear)
- Solar Reflect® windscreen
- Additional rear heating (only in conjunction with front and rear air conditioning)
- CD 70 stereo radio/CD player with MP3 format, satellite navigation with colour monitor and steering wheel mounted audio controls
- Steering wheel mounted audio controls
- Factory-fit telephone pre-wiring
- Speed limiter
- 16-inch alloy wheels (steel spare)
- 16-inch recessed alloy wheels (steel spare)
- Rear parking distance sensors
- Glazed twin rear doors with heated windows and wash/wipe facility
- Two-coat metallic or pearlescent paint
- Special paint (please consult your retailer)

## Engines

load-adaptable gas-pressure dampers.

	2.0CDTI 16v (90PS)	2.0CDTI 16v (115PS)
Fuel type	Diesel	Diesel
Capacity	1995cc	1995cc
Maximum power	90PS (66kW) @ 3500rpm	115PS (84kW) @ 3500rpm
Maximum torque	240Nm (177 lb.ft.) @ 1500rpm	290Nm (214 lb.ft.) @ 1600rpm
Layout	4 cylinders, 4 valves per cylinder, double overhead camshafts	
Fuel/induction system	Turbocharger and common rail fuel injection	
Service interval	18,000 miles or one-year (whichever occurs sooner)	

## Fuel consumption and emissions

Vivaro 9-seat Combi	Fuel economy mpg (litres/100km)			CO <sub>2</sub> (g/km)
	Urban driving	Extra-urban driving	Combined figure	
2.0CDTI 16v (90PS)	28.8 (9.8)	40.4 (7.0)	35.8 (7.9)	214
2.0CDTI 16v (115PS)	27.7 (10.2)	38.2 (7.4)	33.6 (8.4)	224

The fuel consumption figures shown comply with EC directive 1999/100 to provide a realistic indication of fuel consumption by taking into account everyday driving conditions, such as cold starts, acceleration and braking. These figures take account of the vehicle's kerbweight, ascertained in accordance with the above regulation. **Important:** the results given relate to the particular vehicle tested. Variations in trim level and equipment may result in slightly higher fuel consumption and CO<sub>2</sub> emission levels than those quoted. Driving style, road and traffic conditions, vehicle mileage and standard of maintenance may also affect fuel consumption; therefore the results do not express or imply any guarantee of fuel consumption attainable.

## Weights kg

Model	Kerbweight	GVW
SWB 2.0CDTI 16v (90PS)	1885	2920
LWB 2.0CDTI 16v (115PS)	1946	3040

**Note:** Kerbweights include coolant, oil, 90% full fuel tank and spare wheel. They will vary according to the vehicle specification (including options and accessories) with a corresponding variation in carrying capacity. **Gross plated weights** (including axle weights) quoted on the vehicle plate must never be exceeded. **Towing weights** (where applicable) should not exceed 750kg (unbraked trailer) or 2000kg (braked trailer). **Roof load** should not exceed 200kg including the weight of the roof rack/cARRIER.

## Transmission

- Front-wheel drive
- Six-speed manual gearbox

## Steering

- Power-assisted rack and pinion system
- Turning circle (kerb-to-kerb):  
SWB – 11.84m (38.8 ft.)  
LWB – 13.17m (43.2 ft.)
- Turns lock-to-lock: 3.3

## Suspension

**Front:** Independent wishbones with MacPherson spring struts, control arms and separate galvanised, double isolated, vibration reducing subframe.

**Rear:** Semi-independent with trailing links, progressive-rate mini-block coil springs with rubber bump-stops and telescopic.

## Brakes

**Front ventilated disc brakes:**

305mm diameter.

**Rear disc brakes:**

280mm diameter.

## Wheels and tyres

- 6J x 16 steel wheels
- 205/65 R 16 tyres
- Full-size spare wheel with lock

## Fuel tank capacity

- 90 litres (19.8 gallons)



## LWB 12-seat Minibus

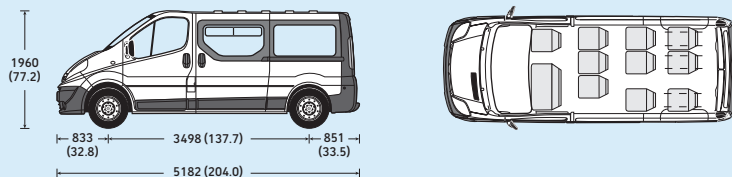

Measurements are shown in millimetres (inches). All heights are shown unladen.

### Tachograph legislation\*

Tachographs are compulsory on any minibus with 10 seats or more that is used for commercial purposes and must be specified at time of ordering as they cannot be fitted retrospectively. Exemptions apply, it is advisable that operators seek independent advice or consult the Commercial Vehicle Specialist at your Vauxhall retailer. Alternatively your local DVLA office will also be able to provide clarification of the relevant legislation.

Due to their precise operational requirements, digital tachographs are not pre-calibrated. Legal requirements dictate that they must be calibrated by an approved tachograph centre within 14 days of the vehicle's registration.

### Safety and security

- Driver's airbag
- Pyrotechnic body-lock front seatbelt pretensioners
- Inertia-reel lap and diagonal seatbelts
- Anti-lock Braking System (ABS) with Electronic Brakeforce Distribution (EBD)
- Emergency Brake Assist (EBA)
- Head restraints to all seats
- Front door side-impact protection beams
- Digital tachograph\* (model specific – mandates CD 413 stereo radio/CD player)
- Two-litre fire extinguisher
- First aid kit
- M1 Type Approval standard for all rear seatbelt anchorages (see page 19 for details)
- Electronic engine deadlock immobiliser

### Interior features

- Facia-mounted gear lever
- Steering column adjustable for reach
- Rev counter
- Central door locking
- Six-way adjustable driver's seat
- Dual front passengers' bench seat
- Punch cloth seat trim
- CD 30 MP3 stereo radio/CD with MP3 format and remote multi-function display (non tachograph model)
- CD 413 stereo radio/CD player (tachograph model)
- Speed limiter
- Full-length soft-trimmed headlining
- Air-blend heater with four-speed fan
- Rubber cab floor covering
- Slip-resistant rear floor covering
- Passenger assist grab handles
- Cab and saloon lighting
- Six individual second/third-row fixed seats
- Three individual fourth-row 'Quiklok' removable seats
- Full-height interior side mouldings

### Exterior features

- Tinted glass
- Electric Pack: comprising electrically operated front windows and electrically adjustable/heated door mirrors
- Nearside sliding side-access door
- Top sliding side window fitted to nearside sliding door and opposite panel
- Glazed rear doors with heated windows and wash/wipe facility
- High level brake light
- Body side-protection mouldings

**Please note:** Full specification details for the Vivaro range appear in the Vivaro brochure available from your Vauxhall retailer or Lo-Call 0845 600 1500.

### Vauxhall Assistance and warranties\*\*

Every Vivaro comes with:

- A one-year unlimited mileage manufacturer's warranty
- Second and third year no-fee customer option warranty up to 100,000 miles from date of first registration
- Vauxhall Assistance for 12 months from date of first registration
- Six-year body panel anti-perforation warranty

\*\* = Warranty is only available on vehicles sourced from Vauxhall Motors Ltd. Terms and conditions apply – please see your Vauxhall retailer for details.

## Optional features at extra cost

- Front passengers' twin airbag
- Electronic Stability Programme-plus (ESP-plus)
- Driver's seat with lumbar adjustment and armrest
- Air conditioning (front only)
- Solar Reflect® windscreen
- CD 70 stereo radio/CD player with MP3 format, satellite navigation with colour monitor and steering wheel mounted audio controls (not available in conjunction with tachograph model)
- Steering wheel mounted audio controls
- Factory-fit telephone pre-wiring
- 16-inch alloy wheels (steel spare)
- 16-inch recessed alloy wheels (steel spare)
- Rear parking distance sensors
- Two-coat metallic or pearlescent paint
- Special paint (please consult your retailer)

## Engine

	2.0CDTI 16v (115PS)
Fuel type	Diesel
Capacity	1995cc
Maximum power	115PS (84kW) @ 3500rpm
Maximum torque	290Nm (214 lb.ft.) @ 1600rpm
Layout	4 cylinders, 4 valves per cylinder; double overhead camshafts
Fuel/induction system	Turbocharger and common rail fuel injection
Service interval	18,000 miles or one-year (whichever occurs sooner)

## Weights kg

Model	Kerbweight	GVW
2.0CDTI 16v (115PS)	2141	3070

**Note:** Kerbweights include coolant, oil, 90% full fuel tank and spare wheel. They will vary according to the vehicle specification (including options and accessories) with a corresponding variation in carrying capacity. **Gross plated weights** (including axle weights) quoted on the vehicle plate must never be exceeded. **Towing weights** (where applicable) should not exceed 750kg (unbraked trailer) or 2000kg (braked trailer). **Roof load** should not exceed 200kg including the weight of the roof rack/carrier.

## Transmission

- Front-wheel drive
- Six-speed manual gearbox

## Steering

- Power-assisted rack and pinion system
- Turning circle (kerb-to-kerb): 13.17m (43.2 ft.)
- Turns lock-to-lock: 3.3

## Suspension

**Front:** Independent wishbones with MacPherson spring struts, control arms and separate galvanised, double isolated, vibration reducing subframe.

**Rear:** Semi-independent with trailing links, progressive-rate mini-block coil springs with rubber bump-stops and telescopic, load-adaptable gas-pressure dampers.

## Brakes

### Front ventilated disc brakes:

305mm diameter.

### Rear disc brakes:

280mm diameter.

## Wheels and tyres

- 6J x 16 steel wheels
- 205/65 R 16 tyres
- Full-size spare wheel with lock

## Fuel tank capacity

- 90 litres (19.8 gallons)

## What is M1 testing?

European test procedures are calculated on the basis that seatbelt loading in an accident is likely to be higher in smaller vehicles because the deceleration rate is greater. The anchorage requirements therefore vary according to the category of vehicle. An M1 category vehicle is one which is used for the carriage of passengers and has no more than eight seats in addition to the driver's seat; an M2 category vehicle has more than eight seats in addition to the driver's seat and a maximum weight not exceeding five tonnes. Although Vivaro and Movano minibuses fall into this latter category, to ensure optimum safety, Vauxhall has insisted that these minibuses are tested to ECE regulation 14.05 at M1 loading, which requires the seatbelt and their anchorages to perform satisfactorily under deceleration loading of 20G – twice that required by the M2 test.

### SWB 6-seat Combi semi-glazed standard roof

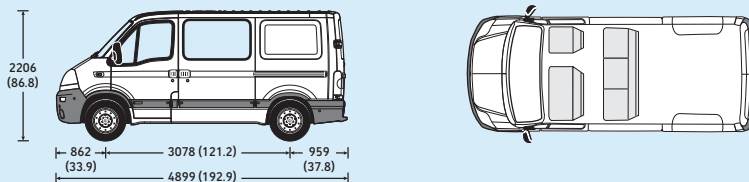

### SWB 9-seat Combi standard roof

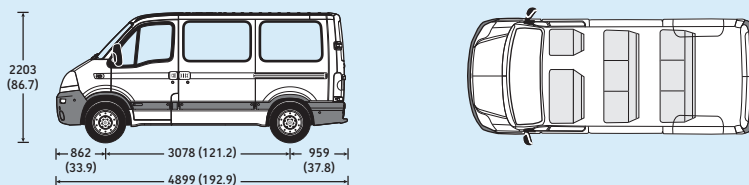

### MWB 6-seat Combi semi-glazed high roof

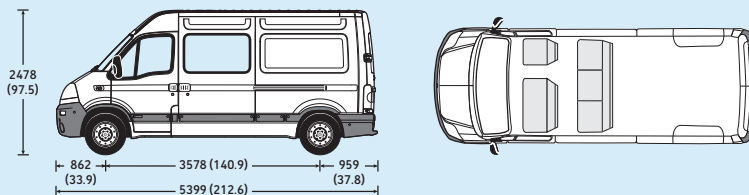

### MWB 9-seat Combi high roof

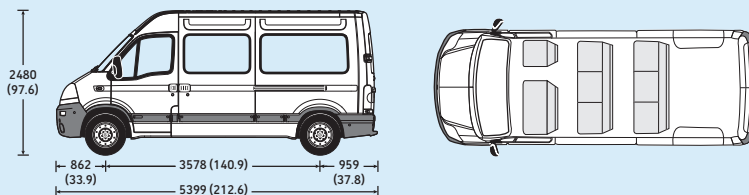

Measurements are shown in millimetres (inches). All heights are shown unladen.

### Safety and security

- Driver's airbag and pyrotechnic body-lock seatbelt pretensioner
- Inertia-reel lap and diagonal seatbelts
- Height-adjustable outer front seatbelts
- Anti-lock Braking System (ABS) with Electronic Brakeforce Distribution (EBD)
- Emergency Brake Assist (EBA)
- Height-adjustable padded front head restraints
- Padded head restraints
- Remote control central locking
- Automatic door locking at speeds over 4mph
- Electronic engine deadlock immobiliser
- M1 Type Approval standard for all rear seatbelt anchorages (see page 19 for details)

### Interior features

- Facia-mounted gear lever
- Eight-way adjustable driver's seat
- Dual front passengers' bench seat with underseat storage tray
- Three individual second-row seats
- Three individual third-row seats (9-seat)
- Stereo radio/CD player
- New Orleans cloth seat trim
- Full-length soft-trimmed headlining (SWB only)
- Air blend heater with four-speed fan
- Slip-resistant floor covering
- Full-height side panelling (SWB only)
- Cab and saloon lighting

### Exterior features

- Tinted glass
- Nearside sliding side-access door
- Fixed window in side-access door and sliding window in opposite panel
- Unglazed rear side panels (6-seat)
- Fixed window to rear side panels (9-seat)
- Glazed rear doors with heated windows
- High level brake light
- Body side-protection mouldings
- Reinforced rear suspension (2800 models)

**Please note:** Full specification details for the Movano range appear in the Movano brochure available from your Vauxhall retailer or Lo-Call 0845 600 1500.

### Vauxhall Assistance and warranties\*

Every Movano comes with:

- A one-year unlimited mileage manufacturer's warranty
- Second and third year no-fee customer option warranty up to 100,000 miles from date of first registration
- Vauxhall Assistance for 12 months from date of first registration
- Six-year body panel anti-perforation warranty

\* = Warranty is only available on vehicles sourced from Vauxhall Motors Ltd. Terms and conditions apply - please see your Vauxhall retailer for details.



## Optional features at extra cost

- Electric Pack: comprising electrically operated front windows and electrically adjustable/heated door mirrors
- Technical Pack: comprising cruise control, with driver controllable speed limiter and trip computer
- Front passengers' twin airbag and pyrotechnic body-lock seatbelt pretensioner
- Electronic Stability Programme-plus
- Remote control ultrasonic security alarm system
- Single front passenger's seat (no-cost option)
- Single fully adjustable 'comfort' front passenger's seat with armrest
- Multi-function front passenger's bench seat with underseat storage
- Trip computer
- Digital tachograph\*\*
- Tilting glass sunroof for saloon area
- Stereo radio/CD player/satellite navigation
- Stereo radio/cassette player (no-cost option)
- Delete spare wheel (includes tyre repair kit)
- Speed limiter
- Height-adjustable pneumatic rear suspension (not available with ESP-plus)
- Reinforced rear suspension (3500 models)
- Tow bar (includes reinforced rear suspension on 3500 models)
- Rain-sensitive windscreen wipers and Automatic Lighting Control (ALC)
- Six-pin connector in battery compartment
- Rear parking distance sensors
- Two-coat metallic paint
- Special paint (please consult your retailer)

\*\* = The digital tachograph option must be specified at time of ordering as it cannot be fitted retrospectively. Option price for digital tachograph does not include calibration which must be carried out at an approved tachograph centre within 14 days of the vehicles registration. **Please note:** The legislation regarding the use of tachographs is complex and operators should seek independent advice or speak to the Commercial Vehicle specialist within a Vauxhall retailer to ensure compliance. Alternatively your local DVLA office will also be able to provide clarification of the relevant legislation.

## Engines

	2.5CDTI 16v (100PS)	2.5CDTI 16v (146PS)
Fuel type	Diesel	Diesel
Capacity	2463cc	2463cc
Maximum power	100PS (74kW) @ 3500rpm	146PS (107kW) @ 3500rpm
Maximum torque	260Nm (192 lb.ft.) @ 1600rpm	320Nm (236 lb.ft.) @ 1500rpm
Layout	4 cylinders, 4 valves per cylinder, double overhead camshafts	
Fuel/Induction system	Fixed geometry turbocharger and intercooler. Common rail fuel injection	Variable geometry turbocharger and intercooler. Common rail fuel injection
Service interval	18,000 miles or one-year (whichever occurs sooner)	

## Fuel consumption and emissions

SWB Movano 6/9-seat Combi	Fuel economy mpg (litres/100km)			CO <sub>2</sub> (g/km)
	Urban driving	Extra-urban driving	Combined figure	
2.5CDTI 16v (100PS)	26.6 (10.6)	36.7 (7.7)	32.5 (8.7)	230
2.5CDTI 16v (146PS)	25.9 (10.9)	36.7 (7.7)	31.7 (8.9)	235

The fuel consumption figures shown comply with EC directive 1999/100 to provide a realistic indication of fuel consumption by taking into account everyday driving conditions, such as cold starts, acceleration and braking. These figures take account of the vehicle's kerbweight, ascertained in accordance with the above regulation. Important: the results given relate to the particular vehicle tested. Variations in trim level and equipment may result in slightly higher fuel consumption and CO<sub>2</sub> emission levels than those quoted. Driving style, road and traffic conditions, vehicle mileage and standard of maintenance may also affect fuel consumption; therefore the results do not express or imply any guarantee of fuel consumption attainable.

## Kerbweight (Gross Vehicle Weight) kg

Model	2800 SWB Combi standard roof		3500 MWB Combi high roof	
	6-seat semi-glazed	9-seat fully glazed	6-seat semi-glazed	9-seat fully glazed
2.5CDTI 16v (100PS)	1901 (2800)	1977 (2800)	1992 (3500)	2065 (3500)
2.5CDTI 16v (100PS) Tecshift	-	-	2001 (3500)	2073 (3500)
2.5CDTI 16v (146PS)	-	1993 (2800)	-	2081 (3500)

**Note:** Kerbweights include coolant, oil, 90% full fuel tank and spare wheel. They will vary according to the vehicle specification (including options and accessories) with a corresponding variation in carrying capacity. **Gross plated weights** (including axle weights) quoted on the vehicle plate must never be exceeded. **Towing weights** should not exceed 750kg (unbraked trailer) or 2000kg (braked trailer). **Roof load** should not exceed 300kg including the weight of the roof rack/carrier.

## Transmissions

- Front-wheel drive
- Six-speed manual gearbox
- Six-speed Tecshift transmission – available at extra cost on MWB models

## Steering

- Power-assisted rack and pinion system
- Turning circle (kerb-to-kerb):  
SWB – 12.07m (39.6 ft.)  
MWB – 13.75m (45.1 ft.)
- Turns lock-to-lock: 3.6

## Suspension

**Front:** Independent double wishbones with coil springs and telescopic dampers. Anti-roll bar.  
**Rear:** Tubular axle with variable-rate reinforced steel double-leaf springs and telescopic dampers. Anti-roll bar. Height-adjustable pneumatic suspension optional at extra cost.

## Fuel tank capacity

- 100 litres (22 gallons)

## Brakes

**Front ventilated disc brakes:**  
305mm diameter.  
**Rear disc brakes:**  
305mm diameter.

## Wheels and tyres

- 6J x 16 steel wheels
- 195/65 R 16 tyres (2800 models)
- 225/65 R 16 tyres (3500 models)

### LWB 15-seat Minibus

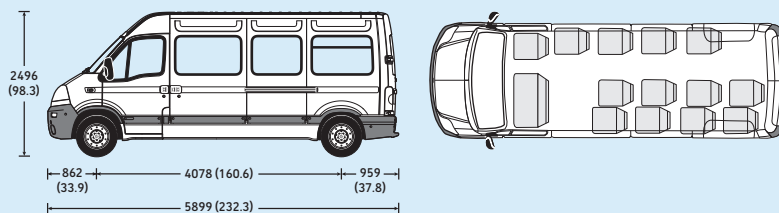

### LWB 16-seat Minibus

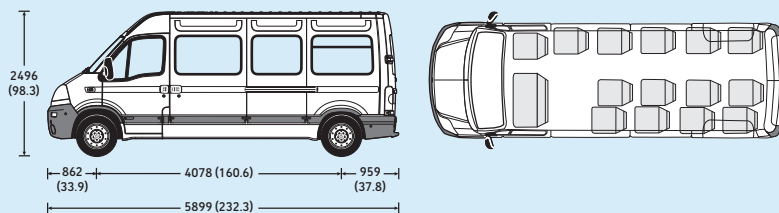

### LWB 17-seat Minibus

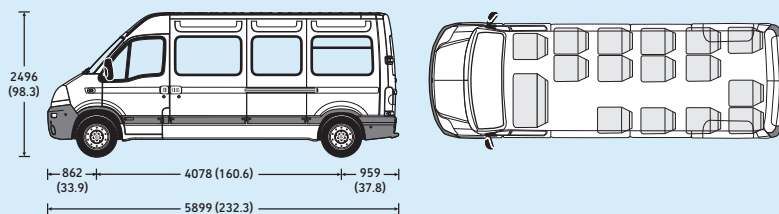

Measurements are shown in millimetres (inches). All heights are shown unladen.

### Tachograph legislation\*

Tachographs are compulsory on any minibus with 10 seats or more that is used for commercial purposes and must be specified at time of ordering as they cannot be fitted retrospectively. Exemptions apply, it is advisable that operators seek independent advice or consult the Commercial Vehicle Specialist at your Vauxhall retailer. Alternatively your local DVLA office will also be able to provide clarification of the relevant legislation.

Due to their precise operational requirements, digital tachographs are not pre-calibrated. Legal requirements dictate that they must be calibrated by an approved tachograph centre within 14 days of the vehicle's registration.

### Safety and security

- PSV compliant
- Driver's airbag
- Front passengers' twin airbag
- Pyrotechnic body-lock seatbelt pretensioners
- Inertia-reel lap and diagonal seatbelts
- M1 Type Approval standard for all rear seatbelt anchorages (see page 19 for details)
- Height-adjustable outer front seatbelts
- Height-adjustable padded front head restraints
- Padded head restraints (15/16-seat)
- Open-type head restraints (17-seat)
- Anti-lock Braking System (ABS) with Electronic Brakeforce Distribution (EBD)
- Emergency Brake Assist (EBA)
- Digital tachograph\*
- Remote control central locking
- Automatic door locking at speeds over 4mph
- Electronic engine deadlock immobiliser
- Speed limiter
- Two-litre fire extinguisher
- First aid kit
- Roof-mounted emergency exit (15/16-seat)
- Two emergency hammers for side windows (15/16-seat)

### Interior features

- Facia-mounted gear lever
- Eight-way adjustable driver's seat
- Dual front passengers' bench seat with underseat storage
- 12, 13 or 14-individual fixed rear seats
- Rear seats staggered for maximum shoulder room (15/16-seat)
- Raised seating with central gangway (15/16-seat)
- Six speakers (15/16-seat)
- Stereo radio/CD player
- New Orleans cloth seat trim
- Full-length soft-trimmed headlining

- Air blend heater with four-speed fan
- Slip-resistant floor covering
- Full-height side panelling
- Cab and saloon lighting
- Lighting to each seat row (15/16-seat)

### Exterior features

- Tinted glass
- Nearside sliding side-access door
- Opening windows in panel opposite side access door and rear side windows (15/16-seat)
- Automatic electrically operated sidestep (15/16-seat)
- Glazed rear doors with heated windows
- High level brake light
- Body side-protection mouldings

**Please note:** Full specification details for the Movano range appear in the Movano brochure available from your Vauxhall retailer or Lo-Call 0845 600 1500.

### Vauxhall Assistance and warranties\*\*

Every Movano comes with:

- A one-year unlimited mileage manufacturer's warranty
- Second and third year no-fee customer option warranty up to 100,000 miles from date of first registration
- Vauxhall Assistance for 12 months from date of first registration
- Six-year body panel anti-perforation warranty

\*\* = Warranty is only available on vehicles sourced from Vauxhall Motors Ltd. Terms and conditions apply - please see your Vauxhall retailer for details.

## Optional features at extra cost available on all models

- Electric Pack: comprising electrically operated front windows and electrically adjustable/heated door mirrors
- Remote control ultrasonic security alarm system
- Multi-function front passenger's bench seat with underseat storage
- Tilting glass sunroof for saloon area
- Stereo radio/CD player/satellite navigation with monochromatic display
- Stereo radio/cassette player (no-cost option)
- Two-coat metallic paint
- Special paint (please consult your retailer)

## Additional optional features at extra cost on 15/16-seat models only

- Front and rear air conditioning
- Rear saloon heating
- Overhead luggage rack
- Luggage rack – 0.5m in lieu of rearmost double seats (no-cost option)
- Luggage rack – 1.0m in lieu of two rearmost double seats (no-cost option)
- Rear parking distance sensors
- Six-pin connector in battery compartment
- Rain-sensitive windscreen wipers and Automatic Lighting Control (ALC)
- Height-adjustable pneumatic rear suspension
- Reinforced rear suspension

## Engines

	2.5CDTI 16v (100PS)	2.5CDTI 16v (120PS)	2.5CDTI 16v (146PS)
Fuel type	Diesel	Diesel	Diesel
Capacity	2463cc	2463cc	2463cc
Maximum power	100PS (74kW) @ 3500rpm	120PS (88kW) @ 3500rpm	146PS (107kW) @ 3500rpm
Maximum torque	260Nm (192 lb.ft.) @ 1600rpm	300Nm (221 lb.ft.) @ 1600rpm	320Nm (236 lb.ft.) @ 1500rpm
Layout	4 cylinders, 4 valves per cylinder, double overhead camshafts		
Fuel/Induction system	Fixed geometry turbocharger and intercooler Common rail fuel injection		Variable geometry turbocharger and intercooler. Common rail fuel injection
Service interval	18,000 miles or one-year (whichever occurs sooner)		

## Kerbweight (Gross Vehicle Weight) kg

Model	3900 LWB Minibus high roof 15-seat	3900 LWB Minibus high roof 16-seat	3900 LWB Minibus high roof 17-seat
2.5CDTI 16v (100PS)	2383 (3900)	2388 (3900)	2395 (3900)
2.5CDTI 16v (100PS) Tecshift	2390 (3900)	2395 (3900)	2402 (3900)
2.5CDTI 16v (120PS)	2383 (3900)	2388 (3900)	2395 (3900)
2.5CDTI 16v (120PS) Tecshift	2390 (3900)	2395 (3900)	2402 (3900)
2.5CDTI 16v (146PS)	2398 (3900)	2398 (3900)	2405 (3900)
2.5CDTI 16v (146PS) Tecshift	2406 (3900)	2411 (3900)	2412 (3900)

**Note:** Kerbweights include coolant, oil, 90% full fuel tank and spare wheel. They will vary according to the vehicle specification (including options and accessories) with a corresponding variation in carrying capacity. **Gross plated weights** (including axle weights) quoted on the vehicle plate must never be exceeded.

## Transmissions

- Front-wheel drive
- Six-speed manual gearbox
- Six-speed Tecshift transmission – available at extra cost

## Steering

- Power-assisted rack and pinion system
- Turning circle (kerb-to-kerb): 15.20m (49.9ft.)
- Turns lock-to-lock: 3.6

## Suspension

**Front:** Independent double wishbones with coil springs and telescopic dampers. Anti-roll bar.  
**Rear:** Tubular axle with variable-rate reinforced steel double-leaf springs and telescopic dampers. Anti-roll bar. Height-adjustable pneumatic suspension optional at extra cost.

## Brakes

**Front ventilated disc brakes:**  
305mm diameter.  
**Rear disc brakes:**  
305mm diameter.

## Wheels and tyres

- 6J x 16 steel wheels
- 225/65 R 16 tyres
- 15-seat: Internally mounted spare wheel
- 16-seat: Tyre inflation kit in lieu of spare wheel
- 17-seat: Underfloor mounted spare wheel

## Fuel tank capacity

- 100 litres (22 gallons)



# Trust Vauxhall

## Protecting the environment

Vauxhall's commitment to the environment is demonstrated by our products' many environmental awards, won both through the use of more recycled materials and by becoming cleaner and more efficient. For information on Vauxhall's efforts to achieve an environmentally sustainable future, see [www.vauxhall.co.uk/recycling](http://www.vauxhall.co.uk/recycling)

## Fleet Customer Services

Our dedicated support services for fleet managers includes factory demonstrators and information on whole life costs, company car and van taxation and finance. For further information please call **0870 010 0651**.

## Sureguard protection

Sureguard Assistance offers the benefits of Vauxhall Assistance for three years from first registration, while Sureguard Warranty also provides a parts and labour warranty for high-mileage or long-term owners. For details contact your local Vauxhall retailer or call **0870 752 7020**.



When you have finished with this brochure please recycle it

The GM Platinum Card is issued by HFC Bank Limited and is available to persons aged 18 years or over and resident in the UK (or 21 and over in the Channel Islands) and is subject to status and conditions. Written quotations are available upon request from The GM Platinum Card, PO Box 3615, Birmingham B3 2RJ. The typical APR quoted is the rate for new customers. Rebate Points are earned on purchases using The GM Platinum Card. Rebate Points are not earned on Balance Transfers or Cash Advances. You earn money off a new Vauxhall/Saab by accumulating Rebate Points under the Rebate Points Programme. General Motors UK Limited is solely responsible for the operation of the Rebate Points Programme, which is subject to the Rebate Points Programme Rules. \*You can redeem up to 2500 Rebate Points subject to the Model Line Maximum which will vary in amount in relation to different Vauxhall/Saab vehicle model lines and unlimited Partner Points. Rebate Points and unlimited Partner Points are redeemable as discounts on a new Vauxhall/Saab vehicle and must be redeemed four years from the issue date. Rebate Points may not be redeemed by Motability Contract Hire customers. The GM Card is a trading name and style of both HFC Bank Limited and General Motors UK Limited. HFC Bank registered in England No. 1117305. Registered Office: North Street, Winkfield, Windsor, Berkshire SL4 4TD is authorised and regulated by the Financial Services Authority. **Member HSBC Group**. HFC Bank Limited is not a member of the same group of companies as General Motors UK Limited, Saab GB Limited or GMAC UK plc. General Motors UK Limited, Registered Office: Griffin House, Osborne Road, Luton, Bedfordshire LU1 3YT. Registered in England number 135767. - CN6/0987.

Every effort has been made to ensure that the contents of this publication were accurate and up-to-date at the time of going to press (July 2008). Vauxhall vehicles are equipped with components manufactured by various General Motors operating units and outside suppliers. The Company reserves the right to alter specifications and withdraw products from sale without notice. Any such alterations will be notified to Vauxhall retailers at the earliest opportunity; please consult your local retailer for the latest information. The specifications detailed within this brochure are not necessarily applicable to alternative models such as Special Editions. Details of any such models will be contained in specific literature or found on the Vauxhall website. Please note that Vauxhall retailers are not the agents of General Motors UK Limited and are not authorised to bind the Company by any specific or implied undertaking or representation. It is advisable to ensure that your motor insurance policy provides adequate cover for additional fitted options and accessories. As part of Vauxhall's policy of environmental care, this brochure is printed on paper manufactured using Elemental Chlorine Free pulps from specially farmed, sustainable timber resources. All rights reserved. No part of this publication may be reproduced in any form or by any means, without the prior written permission of General Motors UK Limited.

VM0808004 Published July 2008 (BMB/Graymatter) General Motors UK Limited, Luton LU1 3YT

## Business Lease

Business Lease, from GMAC, offers the versatility of a purchase-based finance plan, while making the most efficient use of tax and cash-flow benefits for VAT-registered business users. It's available for all Vauxhall Commercial Vehicles up to 12 months old and offers highly flexible term lengths, variable deposits and a choice of payment profiles. Ask your retailer for full details.

## Business First

Available to business users only, Business First enables you to drive a new vehicle without a large, initial financial outlay. You pay to use the vehicle, not to own it. The vehicle is provided over a predetermined period, and when that period comes to an end the vehicle is returned. Ask your retailer for full details.

## Servicing and maintenance

The best way to maximise the performance and reliability of your Vauxhall is to have all routine servicing and maintenance carried out at a Vauxhall Commercial Vehicle retailer. There are over 200 light commercial vehicle and 120 heavy commercial vehicle retailers nationwide.

## In the event of an accident...

Vauxhall Accident Support helps keep you mobile following an accident. Benefits include scene-of-accident advice, message service, assistance with claims and vehicle recovery. For further details call **0800 010 304**.

## Premier Service Centres

Our Premier Service Centres feature a guaranteed same day repair service (provided the parts are in stock) and an appointment-free service for diagnosis and repairs taking less than 90 minutes. All repairs are carried out within 24 hours of diagnosis, while suitable alternative transport can be arranged to keep you mobile.\*

\*= Terms and conditions apply.

## For more information...

For a brochure on any Vauxhall model (up to a maximum of three per caller) or location of your nearest retailer, call **0845 600 1500**.

Alternatively, details can be found on our website at [www.vauxhall.co.uk](http://www.vauxhall.co.uk)



- Save up to **£1000\*** on a new Vauxhall with The GM Card
- 100 Rebate Points worth **£100** when you use The GM Card for the first time
- Rebate Point saving is on top of any discount or offer negotiated with the Retailer
- Earn 3 Rebate Points (**£3**) for every **£100** you spend

**Typical 14.9% APR variable**

To apply call **0845 746 2777** or visit [www.gmcard.co.uk](http://www.gmcard.co.uk).



**VAUXHALL**  
Commercial Vehicles

**The Wheels of Business**